

EMC Ring Core 40 x 24 x 16 mm

Type: R40/24/16

Art.-Nr.: 5S030941

Daten - Caracteristiques - Data

Typical application: EMC filter; Reduction of common mode currents

Core material: Manganese Zinc Ferrite

Type: Cased

Permeability: 5.000 +/-20%

DC resistivity: $\geq 0.5 \Omega m$

AL: 8000 nH +30% / -20%

Hysteresis material const.: ≤ 0.3

Saturation flux density: 400 mT (@ H = 1 kA/m, 25 °C)

Saturation flux density: 260 mT (@ H = 1 kA/m, 100 °C)

Residual flux density: 150 mT

Curie Temp.: $\geq 120 \text{ °C}$

Coercivity: 12A/m

Relative loss factor: $\leq 5.0 @ 10 \text{ kHz} / \leq 20 @ 100 \text{ kHz}$

Dimensions :
 OD: 39.9 mm (+/-0.6 %)
 ID: 24.1mm (+/-0.5 %)
 H: 16.0 mm (+/-0.3 %)

Comments: RoHS II compliant (2011/65/EU)

SO 4.2.2-02 Rev. 1

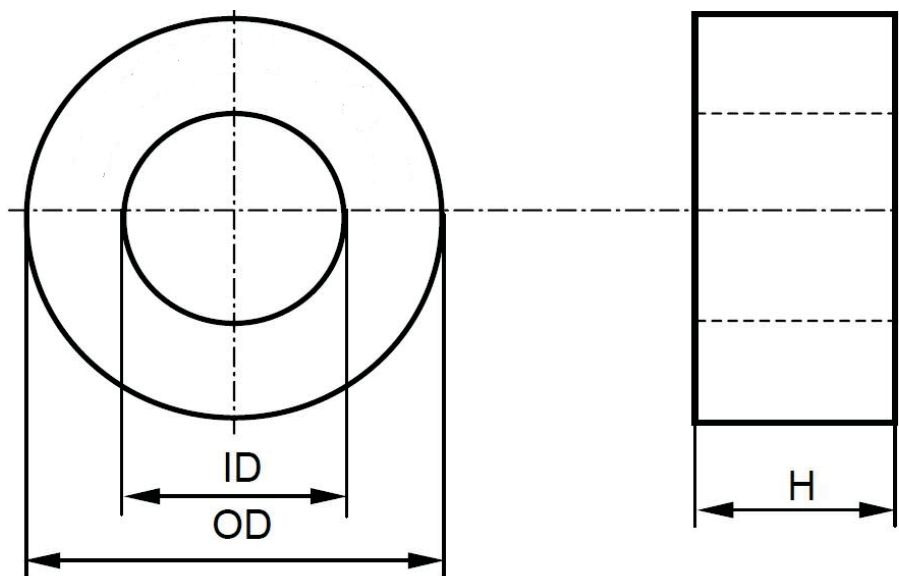

Artikelbild

EPA GmbH - Fliederstraße 8 - 63486 Bruchköbel
 Telefon: +49 (0)6181 9704-0 - Fax: +49 (0)6181 9704-99
 E-Mail: info@epa.de

Issue 0.1 Created by TB Approved by CS Date 03.02.2016