



Accessory equipment for modules and Power Factor Correction Systems on mounting plates

Adjacent to the Capacitor Modules Type C or Power Factor Correction Systems on mounting plates type LSP you need for the construction of a Power Factor Correction Systems further accessory equipment.

Especially for the use in Power Factor Correction Systems FRAKO offers harmonized accessories packages. These include:

- Power Factor Control Relays and accessories
- Mounting plates
- Module rails
- Ventilation packages
- Connecting angles

// Power Factor Control Relays and accessories

For technical details on our Power Factor Control Relays we would like to refer you to chapter "Power Factor Control Relays".

For the relays, **FRAKO** recommend to use the suitable control terminal strips, the thermal trip contact for the monitoring of the cabinet temperature as well as the prepared control cables. All items can be ordered as single components or as a complete control relay package.

The following chart shows the different types of relays as well as the suitable accessories for the assembly and the connection of the devices.

| Order Code | Description | Article-No. |
|-----------------------------------|--|------------------------|
| Power Factor Control Relay | | |
| RM 2106 | with 6 control contacts | 38-00320 |
| RM 9606 | with 6 control contacts (german / english version) | 38-00100 / 38-00103 |
| RM 2112 | with 12 control contacts | 38-00340 |
| EMR 1100 S | with 12 control contacts (german / english version) | 38-00300 / 38-00301 |
| EMR 1100 | with 12 control contacts and bus interface to FRAKO Energy-Management-System | 20-50008 |
| | Software-Upgrade EMR 1100 S to full version EMR 1100 | 20-50013 |

| Control terminal strip with thermal trip contact, pre-mounted | | |
|--|--|----------|
| RKL–RM 9606 | suitable for RM 9606 | 34-80002 |
| RKL–EMR 1100 | suitable for EMR 1100 / EMR 1100 S | 34-80003 |
| RKL–Z–cabinet | for extension units (only 12 control contacts) | 34-80027 |
| Control cable, prepared | | |
| RK RM 9606–1150 | for connection of RM 9606 with control terminal strip (length: 1000 mm, 6 control contacts) | 89-20557 |
| RK RM 9606–1500 | for connection of RM 9606 with control terminal strip (length: 1500 mm, 6 control contacts) | 89-20558 |
| RK EMR 1100–1150 | for connection of EMR 1100 / EMR 1100 S with control terminal strip (length: 1150 mm, 12 control contacts) | 89-20555 |
| RK EMR 1100–1500 | for connection of EMR 1100 / EMR 1100 S with control terminal strip (length: 1500 mm, 12 control contacts) | 89-20556 |
| SS 12–6000 | for connection of the “basic unit” with the “extension unit” (length: 6 m, 12 control contacts) | 89-20559 |
| Reactive Power Factor Control Relay package | | |
| Completely assembled and tested units comprising: | | |
| Power Factor Control Relay with control terminal strip, thermal trip contact and relay cable, length: 1150 mm | | |
| STR–RM 9606 | RM 9606, control terminal strip with thermal trip contact, cable length: 1150 mm | 34-72016 |
| STR–EMR 1100 S | EMR 1100 S, control terminal strip with thermal trip contact, cable length: 1150 mm | 34-72024 |
| STR–EMR 1100 | EMR 1100, control terminal strip with thermal trip contact, cable length: 1150 mm | 34-72002 |

Mounting plates

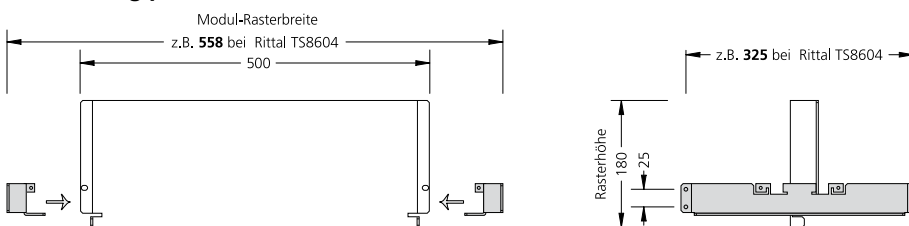

Dimensions of SB-C6 with module rail (here MT-C6-Rittal TS8604)

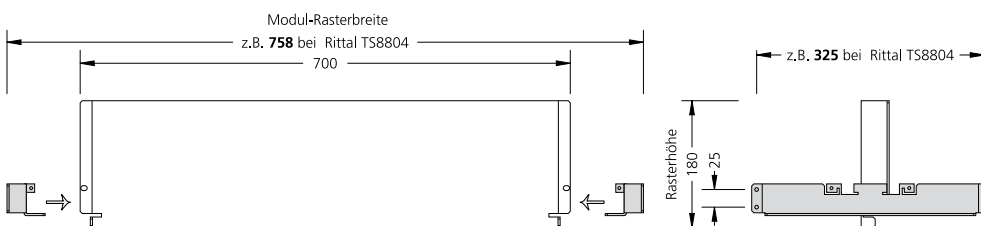

Dimensions of SB-C8 with module rail (here MT-C8-Rittal TS8804)

| When using | Ordering designation | Article-No. |
|--|-----------------------------|--------------------|
| C64 modules, width of the cabinet 600 mm | SB-C6 | 34-80069 |
| C84 modules, width of the cabinet 800 mm | SB-C8 | 34-80053 |

Capacitors in sheet steel cases / Modules

Accessory equipment

// Module rails for diverse cabinet manufacturers

- FRAKO: Mounting rails for FRAKO standard cabinets, depth 400 and 500mm
- Siemens: Mounting rails for Siemens cabinets type SIKUS 3200, SIVACON PT, 8 MF and PU 8
- Moeller: Mounting rails for Moeller cabinets type MODAN 2000, MODAN 6000, ID 2000, GU, SVTL, X-Energy and IVS
- Rittal: Mounting rails for Rittal cabinets TS 8, ES and PS
- Elek: Mounting rails for Elek cabinets type UR and URV
- ABB: Mounting rails for ABB cabinets type MNS and RNS
- Hensel: Mounting rails for Hensel cabinets type SAS 2000
- Striebel & John: Mounting rails for Striebel & John cabinets type XA and Triline R
- Lögstrup: Mounting rails for Lögstrup cabinets
- Mona 5000: Mounting rails for Mona 5000 cabinets
- Mehler: Mounting rails for Mehler- cabinets type ARM and SRM
- Leukhardt: Mounting rails for Leukhardt cabinets type TN
- Elin-EBG: Mounting rails for Elin cabinets type SV
- Weber: Mounting rails for Weber cabinets type PM 8
- AEG: Mounting rails for AEG cabinets type EVS and SEN
- Sarel: Mounting rails for Sarel cabinets type S 6000
- Elsteel: Mounting rails for Elsteel cabinets
- Eldon: Mounting rails for Eldon cabinets type MCS
- ISA 2000: Mounting rails for ISA 2000 cabinets
- Dessauer: Mounting rails for Dessauer cabinets type Dessa Norm
- Hager: Mounting rails for Hager cabinets type FG 22
- ABN: Mounting rails for ABN cabinets
- Lohmeier: Mounting rails for Lohmeier cabinets
- GE VPS Steel: Mounting rails for GE VPS Steel-cabinets
- Natus Energon: Mounting rails for Natue cabinets type Energon

// Ventilation packages

| Ventilation package, consisting of | Ordering designation | Article-No. |
|--|----------------------|-------------|
| Roof vent, internal, 1 pc. intake filter and thermostat | LP-LSFC-I-IP20-6/1 | 34-80096 |
| Roof vent, top mounted, 1 pc. intake filter and thermostat | LP-LSFC-A-IP43-6/1 | 34-80192 |

// Bus bar sets

The copper bus bar sets are used for vertical connection to the bus bar system.

| Application | Ordering designation | Article-No. |
|---------------------------------|----------------------|-------------|
| Vertical connection for C-Modul | CU AW-1 | 34-80006 |

// Connecting angles

The Connecting angles are completely delivered with fastening screws M12 and protection against accidental contact.

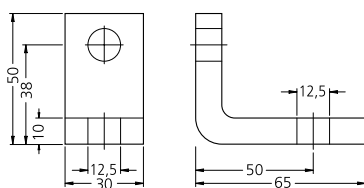

Dimensions of CU AW-1