

# ROSHNI (RO) & ROSHNI LP (ROLP)

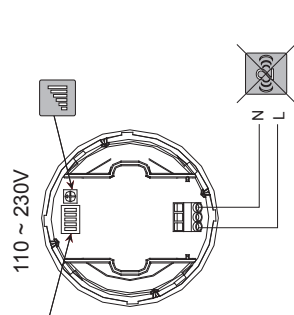

|  |  |  |                        |
|--|--|--|------------------------|
|  | EN54-3   |  | Roshni                 |
|  | ROLP/Roshni                                    |  |                        |
|  | 9 ~ 15VDC                                      | 18 ~ 28VDC                               | 110 ~ 230VAC           |
|  | 30mA max                                       |  | 35mA                   |
|  | 0.28mm <sup>2</sup> ~ 2.5mm <sup>2</sup>       | 0.75mm <sup>2</sup> ~ 2.5mm <sup>2</sup> | 0A Rating              |
|  | -25°C ~ +70°C                                  |  | -10°C ~ +55°C          |
|  | ABS V0   |  | ABS V0                 |
|  | S = Type A = (IP54*)<br>DIU = Type B = (IP65*) |  | IP54 = S<br>IP65 = DIU |
|  | 6  |  | 32                     |

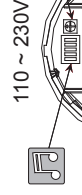
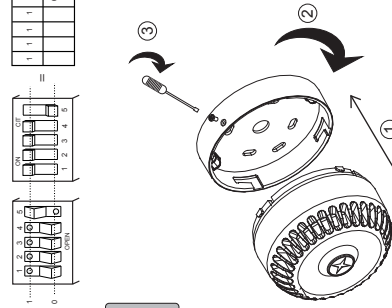
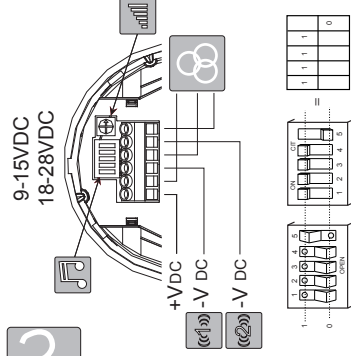
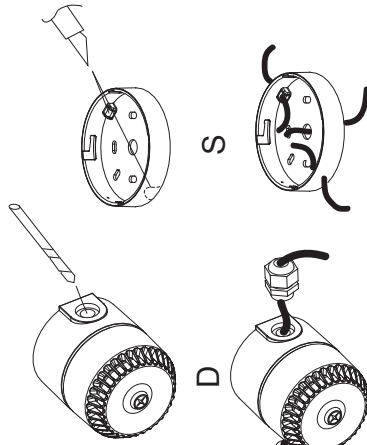
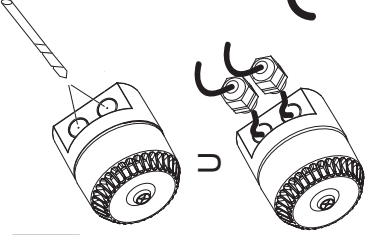
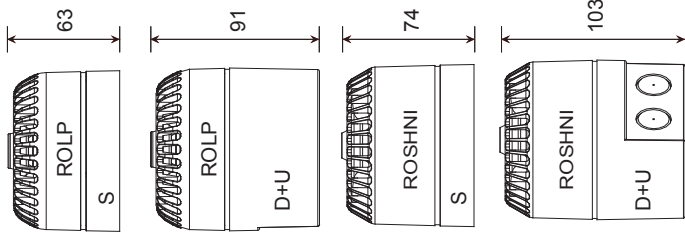
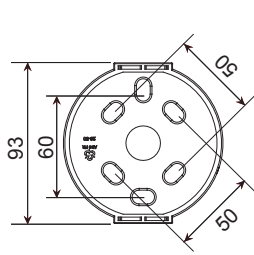

Installation must be in accordance with relevant national wiring regulations or codes for the intended application and voltages employed.

L'installation doit être conforme à la réglementation ou aux codes nationaux de câblage en vigueur, en vue de l'application désirée et des tensions utilisées.

Das Gerät ist für die vorgesehene Anwendung unter Verwendung gemäß relevanten nationalen Vorschriften und Regeln zur Verabelung zu installieren.

L'installazione deve essere eseguita in conformità con le disposizioni nazionali vigenti sul cablaggio o i corrispondenti codici per l'applicazione prevista e le tensioni impiegate.

Instalatie moet overeenstemmen met relevante nationale wetgeving of codes voor kabels bij de benoemde toepassing en gebruikte voltages.

La instalación debe estar acorde con las principales normas nacionales para cableado o códigos para la aplicación prevista y los voltajes empleados.

Instalace musí být v souladu s platnými předpisy pro napájení elektrických kabelů v dané aplikaci a napětí, ke kterým je zařízení určeno.

Den aktuelle spänning.

|  |                           | Main Application   |     | Roshni LP (ROLP)   |       |
|--|---------------------------|--------------------|-----|--------------------|-------|
|  |                           | *12Vdc on axis @1M | mA  | *24Vdc on axis @1M | dB(A) |
|  | BS Fire                   | 6                  | 95  | 13                 | 101   |
|  | BS Fire                   | 8                  | 94  | 12                 | 100   |
|  | BS Fire                   | 6                  | 95  | 12                 | 102   |
|  | General Purpose           | 16                 | 99  | 32                 | 105   |
|  | General Purpose           | 16                 | 103 | 32                 | 109   |
|  | General Purpose           | 16                 | 105 | 32                 | 112   |
|  | Dutch fire (NEN 2575)     | 6                  | 97  | 12                 | 103   |
|  | German fire (DIN 33.404)  | 7                  | 96  | 15                 | 103   |
|  | General Purpose           | 15                 | 99  | 31                 | 105   |
|  | PFEER alert               | 5                  | 95  | 8                  | 101   |
|  | BS Fire                   | 6                  | 95  | 12                 | 101   |
|  | General Purpose           | 9                  | 99  | 17                 | 105   |
|  | General Purpose           | 3                  | 94  | 5                  | 101   |
|  | PFEER toxic gas           | 7                  | 95  | 14                 | 101   |
|  | French fire (NF S 32-001) | 8                  | 96  | 17                 | 102   |
|  | Swedish (Air Raid)        | 4                  | 94  | 6                  | 100   |
|  | Swedish (Local warning)   | 4                  | 95  | 7                  | 101   |
|  | Swedish (Pre-mess)        | 3                  | 95  | 6                  | 101   |
|  | Swedish (All clean)       | 5                  | 95  | 10                 | 101   |
|  | Swedish (Turn out)        | 7                  | 96  | 16                 | 102   |
|  | Swedish general purpose   | 4                  | 94  | 6                  | 101   |
|  | Pelican crossing          | 12                 | 98  | 27                 | 104   |
|  | BS Fire                   | 6                  | 93  | 12                 | 100   |
|  | General Purpose           | 15                 | 102 | 32                 | 108   |
|  | ISO 8201                  | 4                  | 95  | 7                  | 101   |
|  | ISO 8201                  | 4                  | 95  | 6                  | 102   |
|  | ISO 8201                  | 3                  | 94  | 6                  | 101   |
|  | BS Fire                   | 6                  | 95  | 12                 | 101   |
|  | BS Fire                   | 10                 | 99  | 20                 | 105   |
|  | BS Fire                   | 8                  | 94  | 16                 | 100   |
|  | BS Fire                   | 10                 | 98  | 14                 | 103   |
|  | BS Fire                   | 8                  | 95  | 16                 | 100   |

|  |                           | Main Application   |     | Roshni LP (ROLP)   |       |
|--|---------------------------|--------------------|-----|--------------------|-------|
|  |                           | *12Vdc on axis @1M | mA  | *24Vdc on axis @1M | dB(A) |
|  | BS Fire                   | 6                  | 95  | 13                 | 101   |
|  | BS Fire                   | 8                  | 94  | 12                 | 100   |
|  | BS Fire                   | 6                  | 95  | 12                 | 102   |
|  | General Purpose           | 16                 | 99  | 32                 | 105   |
|  | General Purpose           | 16                 | 103 | 32                 | 109   |
|  | General Purpose           | 16                 | 105 | 32                 | 112   |
|  | Dutch fire (NEN 2575)     | 6                  | 97  | 12                 | 103   |
|  | German fire (DIN 33.404)  | 7                  | 96  | 15                 | 103   |
|  | General Purpose           | 15                 | 99  | 31                 | 105   |
|  | PFEER alert               | 5                  | 95  | 8                  | 101   |
|  | BS Fire                   | 6                  | 95  | 12                 | 101   |
|  | General Purpose           | 9                  | 99  | 17                 | 105   |
|  | General Purpose           | 3                  | 94  | 5                  | 101   |
|  | PFEER toxic gas           | 7                  | 95  | 14                 | 101   |
|  | French fire (NF S 32-001) | 8                  | 96  | 17                 | 102   |
|  | Swedish (Air Raid)        | 4                  | 94  | 6                  | 100   |
|  | Swedish (Local warning)   | 4                  | 95  | 7                  | 101   |
|  | Swedish (Pre-mess)        | 3                  | 95  | 6                  | 101   |
|  | Swedish (All clean)       | 5                  | 95  | 10                 | 101   |
|  | Swedish (Turn out)        | 7                  | 96  | 16                 | 102   |
|  | Swedish general purpose   | 4                  | 94  | 6                  | 101   |
|  | Pelican crossing          | 12                 | 98  | 27                 | 104   |
|  | BS Fire                   | 6                  | 93  | 12                 | 100   |
|  | General Purpose           | 15                 | 102 | 32                 | 108   |
|  | ISO 8201                  | 4                  | 95  | 7                  | 101   |
|  | ISO 8201                  | 4                  | 95  | 6                  | 102   |
|  | ISO 8201                  | 3                  | 94  | 6                  | 101   |
|  | BS Fire                   | 6                  | 95  | 12                 | 101   |
|  | BS Fire                   | 10                 | 99  | 20                 | 105   |
|  | BS Fire                   | 8                  | 94  | 16                 | 100   |
|  | BS Fire                   | 10                 | 98  | 14                 | 103   |
|  | BS Fire                   | 8                  | 95  | 16                 | 100   |

(i) All other SPL measurements are taken 'on axis' & are not third party verified.  
 (ii) Toutes les autres mesures NPA sont relevées « sur axe » et ne sont pas vérifiées par un tiers.  
 (iii) Alle anderen Schalldruckmessungen wurden vom akustischen Mittelpunkt ab gelesen und von keiner unabhängigen Stelle verifiziert.  
 (iv) Tutte le altre misurazioni SPL sono state rilevate "sull'asse" e non sono state verificate da terzi.  
 (v) Alle andere SPL-metingen zijn via de 'as' gedaan en niet door derden geverifieerd.  
 (vi) Cualquier otra medida del SPL (nivel de intensidad acústica) se toma "sobre el eje" y no está verificada por terceros partes.  
 (vii) Alla övriga mätningar av ljudtryck har genomförts "direkt inll" och är inte bekräftade av tredje part.