

ENC05A

ADOAH040MSN0005H04/1G/1D

Connection technology

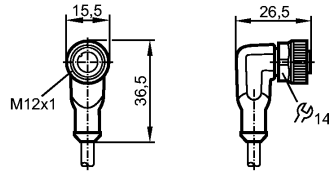

Product characteristics

Socket	
For sensors with	
M12 connector	
Free from silicone	
compatible with paint	
Gold-plated contacts	
ATEX approval	
Group II, category 1G	
Group II, category 1D	

Electrical data

Electrical design		DC
Operating voltage [V]		...30 DC
Current rating [A]		1
Max. input power		Group II: 1 W Group IIIB: 1 W Group IIIC: 550 mW (at Ta max. 90 °C) / 650 mW (at Ta max. 70 °C) / 750 mW (at Ta max. 40 °C)
Protection class		II

Environment

Ambient temperature [°C]		-25...90, for use in hazardous areas: ambient temperature in accordance with unit marking
Protection		IP 67; IP68/IP69K outside hazardous areas

Tests / approvals

Approval		BVS 11 ATEX E 009 X IECEX BVS 11.0002 X
Marking of the unit		<p>⊕ II 1G Ex ia IIB T6 Ga Ta: -25...80°C</p> <p>⊕ II 2G Ex ia IIC T6 Gb</p> <p>⊕ II 1D Ex ia IIIC T85°C Da</p> <p>⊕ II 1G Ex ia IIB T5 Ga Ta: -25...90°C</p> <p>⊕ II 2G Ex ia IIC T5 Gb</p> <p>⊕ II 1D Ex ia IIIC T95°C Da</p>

Safety classification

Internal capacitance [nF]		0.5
Internal inductance [μH]		10

Mechanical data

Design		angled
Material body		housing: TPU orange; sealing: Viton

ENC05A

ADOAH040MSN0005H04/1G/1D

Connection technology

Material nut	Brass; nickel-plated
Tightening torque for knurled nut [Nm]	0.6...1.5
Weight [kg]	0.174

Electrical connection

Connection	PUR cable / 5 m; 4 x 0.34 mm ² (42 x Ø 0.1 mm); Ø 4.9 mm; halogen-free
Sheath colour	blue

Wiring

Core colours

BK black
BN brown
BU blue
WH white

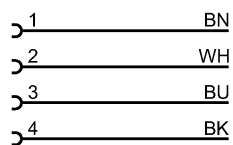
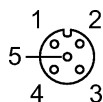

Remarks

Remarks	Special conditions for safe operation apply for use in hazardous areas. Observe the corresponding notes in the operating instructions (Ex protection related part).
---------	---

Pack quantity [piece]	1
-----------------------	---