

Data-Sheet Top-Hat Rails

produced according to EN 60715

status: 05.2011

Top-Hat Rails are roll-forming manufactured from zinc-coated or subsequently elec. zinc-plated band steel. They can be used to accommodate appliances in control panel cabinets, distribution boxes and the like.

Properties:

Material:	sheet steel zinc-plated 7...20 μm sheet steel elec. zinc-plated 2,5...10 μm
Working temperature:	arbitrary
Delivery Length:	2000 mm
Comparable copper cross-section:	at H=7,5 mm → A \approx 16 mm ² at H=10 mm → A \approx 16 mm ² at H=15 mm → A \approx 35 mm ²

For more information visit our homepage www.licatec.de.

Versions:

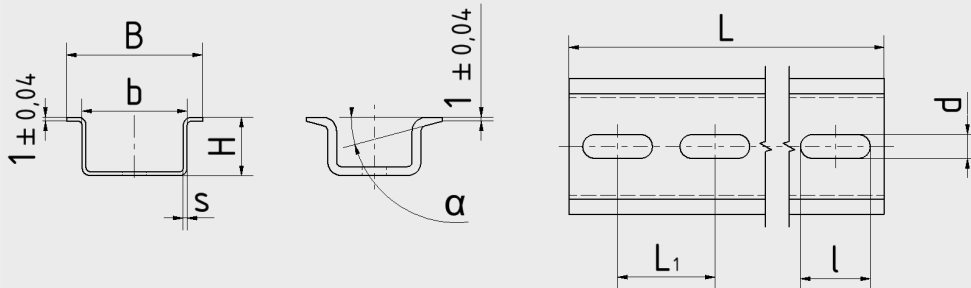

Art.-No.	B	b	H	s	L	L1	l	d	α	m kg/100m	type of zinc-coating
7872	35	27	7,5	1	2000			without bores	0	35	elec. zinc-plated
7892	35	27	7,5	1	2000			without bores	0	35	zinc-plated
7891G-U	35	27	10	1	2000			without bores	0	39	elec. zinc-plated
7891S-U	35	27	10	1	2000			without bores	0	39	zinc-plated
7873	35	27	15	1,5	2000			without bores	15°	66	elec. zinc-plated
7893	35	27	15	1,5	2000			without bores	15°	66	zinc-plated
7875	35	27	7,5	1	2000	25	18	5,2	0	32	elec. zinc-plated
7895	35	27	7,5	1	2000	25	18	5,2	0	32	zinc-plated
7895S-G	35	27	7,5	1	2000	25	15	6,2	0	32	zinc-plated
7895S-G1	35	27	7,5	1	2000	25	18	6,2	0	32	zinc-plated
7891S-G	35	27	10	1	2000	25	18	5,2	0	36	zinc-plated
7891G-G	35	27	10	1	2000	25	18	5,2	0	36	elec. zinc-plated
7876	35	27	15	1,5	2000	25	18	5,2	15°	62	elec. zinc-plated
7896	35	27	15	1,5	2000	25	18	5,2	15°	62	zinc-plated
7897S-G	35	27	15	1,5	2000	25	15	6,2	15°	62	zinc-plated

CE RoHS
konform