



## DC-switch-disconnector 20A

**Part no.** P-SOL20  
**Article no.** 120934  
**Catalog No.** P-SOL20

### Delivery programme

Product range			Switchgear for photovoltaic systems
Subrange			DC switch-disconnectors
Rated operational voltage	U <sub>e</sub>	V	1000
Protection class			2
Number of conductors			2 pole
Max. rated operational current			
Rated operational current 240 V	I <sub>e</sub>	A	20
Design			open

### Approvals

NA Certification  
Specially designed for NA

Request filed for UL and CSA  
No

Rated operational current I <sub>e</sub> at DC-21A	I <sub>e</sub>	A	20
Pole			2 pole
Rated operational voltage	U <sub>e</sub>	V	1000
Isolating characteristics			yes
Standards			IEC/EN 60 947-3 UL-508, TÜV-certified
Lifespan, mechanical	Operations		100000
Electrical		Operations	100000
Max. operating frequency		Ops/h	120
Climatic proofing			Damp heat, constant, to IEC 60068-2-78 Damp heat, cyclic, to IEC 60068-2-30

### Ambient temperature

Open		°C	- 25 - + 60
Mounting position			As required

### Dimensions

Width		mm	58
Height		mm	93
Depth		mm	76

Top-hat rail			35 mm
Weight		kg	0.32

### Terminal capacities

Flexible with ferrule		mm <sup>2</sup>	1 x (1 - 6) 2 x (1 - 6)
Solid or stranded		AWG	18 - 14
Rated short-time withstand current (t=1s)	I <sub>cw</sub>	kA	0.24
up to 440 V 50/60 Hz	I <sub>cm</sub>	kA	0.32
Internal resistance		mΩ	6

### Technical data ETIM 4.0

Version as switch disconnector compact			Yes
Version as main switch			No
Version as maintenance-/service switch			No
Version as safety switch			No
Version as emergency stop installation			No
Max. rated operation voltage U <sub>e</sub> AC		V	0

Rated permanent current I <sub>u</sub>	A	20
Rated operation power AC-3, 400 V	kW	0
Rated operation power at AC-23, 400V	kW	0
Conditioned rated short-circuit current I <sub>q</sub>	kA	0
Number of poles		2
Number of auxiliary contacts as normally closed contact		0
Number of auxiliary contacts as normally open contact		0
Number of auxiliary contacts as change-over contact		0
Motor drive optional		No
Motor drive integrated		No
Voltage release optional		Yes
Device construction		Built-in device fixed built-in technique
Suitable for ground mounting		Yes
Suitable for front mounting		No
Suitable for front mounting center		No
Suitable for distribution board installation		Yes
Suitable for intermediate mounting		No
Type of control element		Turn button (knob)
Interlockable		No
Connection type main current circuit		Clamp bracket
Degree of protection (IP), front side		IP20

## Dimensions

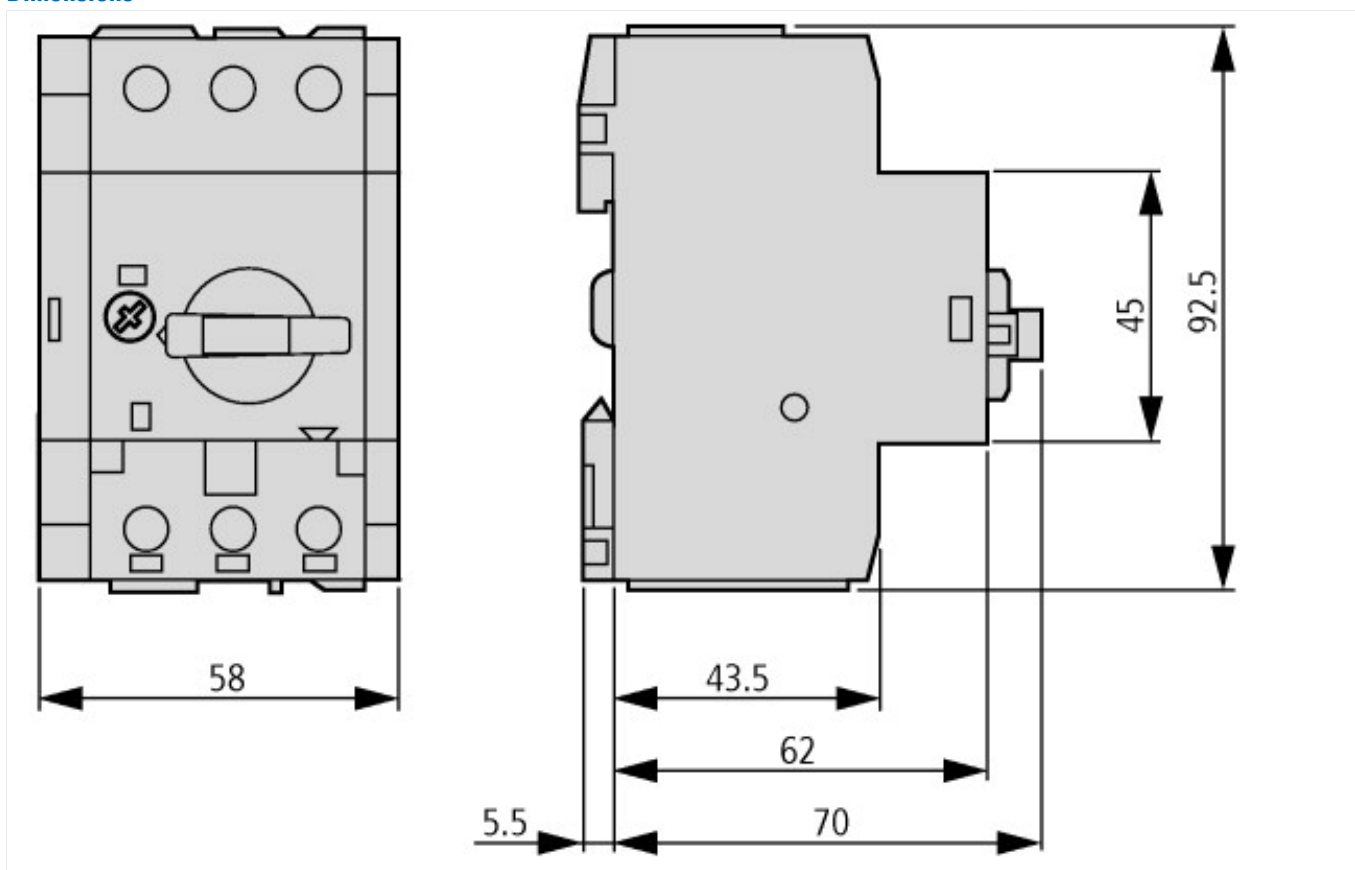

## Additional product information (links)

Motor starters and "Special Purpose Ratings" for the North American market	<a href="http://www.moeller.net/binary/ver_techpapers/ver953en.pdf">http://www.moeller.net/binary/ver_techpapers/ver953en.pdf</a>
Busbar Component Adapters for modern Industrial control panels	<a href="http://www.moeller.net/binary/ver_techpapers/ver960en.pdf">http://www.moeller.net/binary/ver_techpapers/ver960en.pdf</a>