

Reversing load relay - PLC-PT-ELR W1/ 2-24DC



1069556

<https://www.phoenixcontact.com/de/produkte/1069556>

Please be informed that the data shown in this PDF document is generated from our Online Catalog. Please find the complete data in the user documentation. Our General Terms of Use for Downloads are valid.

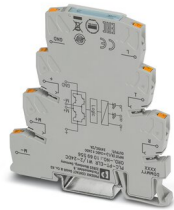

PLC-INTERFACE as an electronic reversing load relay, consisting of PLC-BPT.../21 basic terminal block with Push-in connection and integrated circuit, for driving DC motors, with LED display and protective circuit, output: 10 ... 30 V DC/2 A

Your advantages

- Wear-free reversing
- Short-circuit, surge, and overload-proof output
- Braking by controlling both inputs
- Integrated locking circuit and load wiring

Commercial Data

| | |
|--------------------------------------|---------------------|
| Item number | 1069556 |
| Packing unit | 1 pc |
| Minimum order quantity | 1 pc |
| Sales Key | G1 - Relais |
| Product Key | CK7621 |
| Catalog Page | Page 423 (C-5-2019) |
| GTIN | 4055626744865 |
| Weight per Piece (including packing) | 54,8 g |
| Weight per Piece (excluding packing) | 38,9 g |
| Customs tariff number | 85371098 |
| Country of origin | DE |

Reversing load relay - PLC-PT-ELR W1/ 2-24DC



1069556

<https://www.phoenixcontact.com/de/produkte/1069556>

Technical Data

Notes

Utilization restriction

| | |
|----------|---|
| EMC note | EMC: class A product, see manufacturer's declaration in the download area |
|----------|---|

Product properties

| | |
|----------------|-----------------------|
| Product type | Solid-state contactor |
| Operating mode | 100% operating factor |

Insulation characteristics

| | |
|----------------------|------------------|
| Overvoltage category | II |
| Pollution degree | 2 |
| Insulation | Basic insulation |

Electrical properties

| | |
|---|--------|
| Number of phases | 1 |
| Maximum power dissipation for nominal condition | 0.4 W |
| Rated insulation voltage | 50 V |
| Rated surge voltage | 0.5 kV |

Supply

| | |
|--|-------------------------|
| Input name | Device supply |
| Rated control circuit supply voltage U_S | 24 V DC |
| Control supply voltage range | 19.2 V DC ... 28.8 V DC |

Input data

Control

| | |
|--|---|
| Input name | Control input right/left |
| Rated actuating voltage U_C | 24 V DC |
| Triggering voltage range | 19.2 V DC ... 28.8 V DC |
| Rated actuating current I_C | □ 3 mA |
| Typical response time | 200 μ s |
| Protective circuit | Reverse polarity protection Surge protection |
| Surge voltage protection | > 33 V DC |
| Transmission frequency | 300 Hz |
| Switchover time R_L/L_L (turn-on time) | 80 ms |

Output data

DC output

| | |
|------|---|
| Note | Protect the supply voltage at the output using a suitable fuse. |
|------|---|

Reversing load relay - PLC-PT-ELR W1/ 2-24DC



1069556

<https://www.phoenixcontact.com/de/produkte/1069556>

| | |
|-------------------------------|---|
| Rated operating voltage U_e | 24 V DC |
| Operating voltage range | 10 V DC ... 30 V DC |
| Load current | 2 A |
| Quiescent current | 10 mA |
| Protective circuit | Reverse polarity protection; Polarity protection diode (No continuous protection against polarity reversal) |
| | Surge protection |
| Surge voltage protection | > 33 V DC |

Motor switching output

| | |
|--------------------------|---------------------------------------|
| Note | Short-circuit and overload protection |
| Continuous load current | 2 A (see derating curve) |
| Short-circuit current | 15 A (during braking) |
| Protective circuit | Surge protection |
| | RC element |
| Surge voltage protection | > 33 V DC |

Connection data

| | |
|----------------------------------|--|
| Connection method | Push-in connection |
| Stripping length | 10 mm |
| Conductor cross section solid | 0.14 mm ² ... 2.5 mm ² |
| Conductor cross section flexible | 0.14 mm ² ... 2.5 mm ² |
| | 0.2 mm ² ... 2.5 mm ² (Single ferrule) |
| | 2x 0.5 mm ² ... 1 mm ² (TWIN ferrule) |
| Conductor cross section AWG | 26 ... 14 |

LED signaling

| | |
|---------------------------|------------|
| Status display | Yellow LED |
| Operating voltage display | Green LED |

Dimensions

| | |
|--------|--------|
| Width | 6.5 mm |
| Height | 80 mm |
| Depth | 86 mm |

Material specifications

| | |
|--|----|
| Flammability rating according to UL 94 | V0 |
|--|----|

Environmental and real-life conditions

Ambient conditions

| | |
|---|------------------|
| Degree of protection | IP20 |
| Ambient temperature (operation) | -25 °C ... 60 °C |
| Ambient temperature (storage/transport) | -40 °C ... 85 °C |

Approval data

Reversing load relay - PLC-PT-ELR W1/ 2-24DC



1069556

<https://www.phoenixcontact.com/de/produkte/1069556>

UKCA

| | |
|-------------|----------------|
| Certificate | UKCA-compliant |
|-------------|----------------|

CE

| | |
|-------------|--------------|
| Certificate | CE-compliant |
|-------------|--------------|

Standards and regulations

Air clearances and creepage distances between the power circuits

| | |
|-----------------------|-----------|
| Standards/regulations | IEC 60664 |
| | EN 50178 |

Mounting

| | |
|-----------------------|--------------------------------|
| Mounting type | DIN rail mounting |
| Assembly instructions | in rows with zero spacing |
| Mounting position | Vertical (horizontal DIN rail) |

Reversing load relay - PLC-PT-ELR W1/ 2-24DC

1069556

<https://www.phoenixcontact.com/de/produkte/1069556>

Drawings

Application drawing

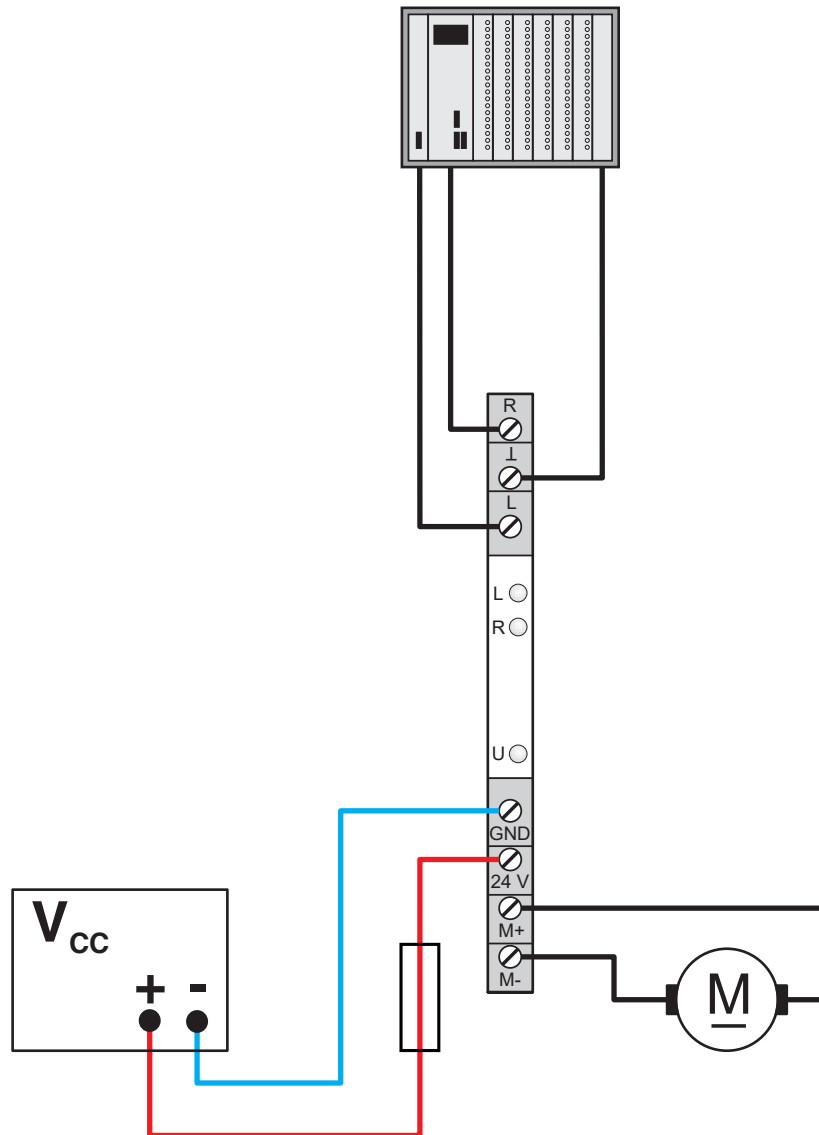

Reversing load relay - PLC-PT-ELR W1/ 2-24DC

1069556

<https://www.phoenixcontact.com/de/produkte/1069556>

Circuit diagram

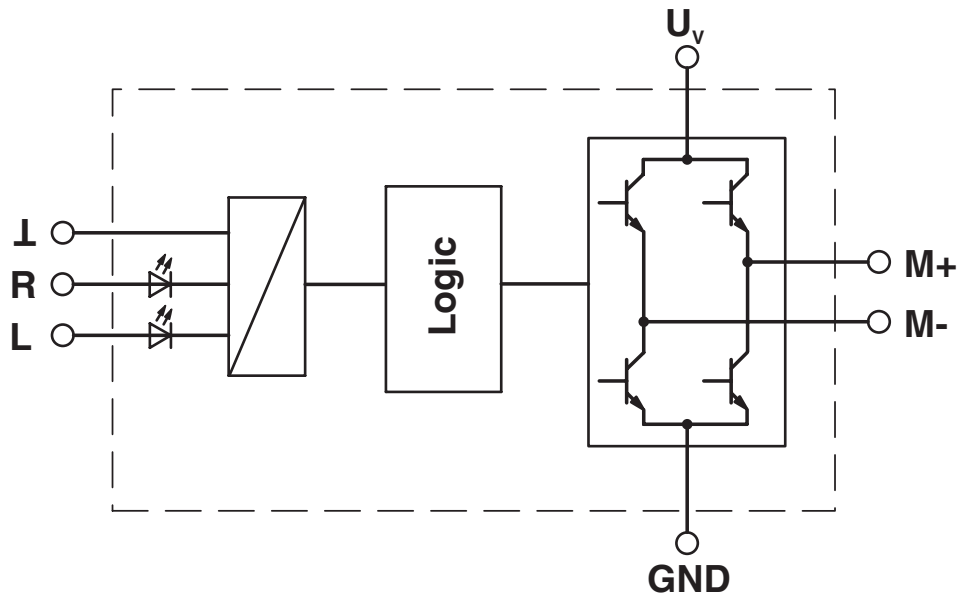

Diagram

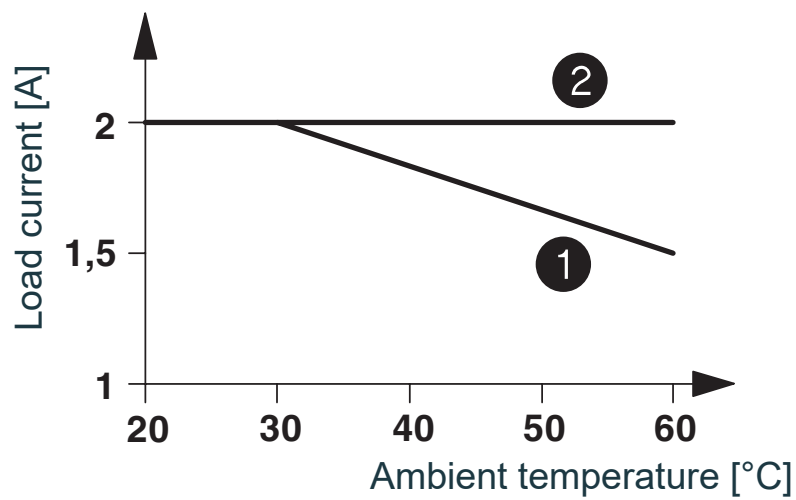

- ① In rows with zero spacing
- ② stand-alone device

Reversing load relay - PLC-PT-ELR W1/ 2-24DC



1069556

<https://www.phoenixcontact.com/de/produkte/1069556>

Approvals



EAC

Approval ID: TR_TS_D_00573_c

Reversing load relay - PLC-PT-ELR W1/ 2-24DC



1069556

<https://www.phoenixcontact.com/de/produkte/1069556>

Classifications

ECLASS

| | |
|---------------|----------|
| ECLASS-9.0 | 27371014 |
| ECLASS-10.0.1 | 27371014 |
| ECLASS-11.0 | 27371014 |

ETIM

| | |
|----------|----------|
| ETIM 8.0 | EC002055 |
|----------|----------|

UNSPSC

| | |
|-------------|----------|
| UNSPSC 21.0 | 39122300 |
|-------------|----------|

Reversing load relay - PLC-PT-ELR W1/ 2-24DC



1069556

<https://www.phoenixcontact.com/de/produkte/1069556>

Environmental Product Compliance

| | |
|------------|--|
| REACH SVHC | Lead 7439-92-1 |
| China RoHS | Environmentally Friendly Use Period = 50 years |
| | For information on hazardous substances, refer to the manufacturer's declaration available under "Downloads" |

Reversing load relay - PLC-PT-ELR W1/ 2-24DC

1069556

<https://www.phoenixcontact.com/de/produkte/1069556>

Accessories

 Note: Applying some accessories below might limit this product.

Continuous plug-in bridge

Continuous plug-in bridge - FBST 500-PLC RD - 2966786

<https://www.phoenixcontact.com/de/produkte/2966786>



Continuous plug-in bridge, color: red

 Max. current carrying capacity: 32 A

Continuous plug-in bridge

Continuous plug-in bridge - FBST 500-PLC BU - 2966692

<https://www.phoenixcontact.com/de/produkte/2966692>

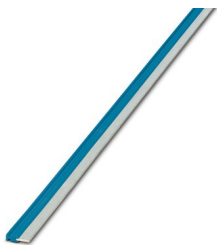

Continuous plug-in bridge, color: blue

 Max. current carrying capacity: 32 A

Reversing load relay - PLC-PT-ELR W1/ 2-24DC

1069556

<https://www.phoenixcontact.com/de/produkte/1069556>

Continuous plug-in bridge

Continuous plug-in bridge - FBST 500-PLC GY - 2966838

<https://www.phoenixcontact.com/de/produkte/2966838>



Continuous plug-in bridge, color: gray

 Max. current carrying capacity: 32 A

Single plug-in bridge

Single plug-in bridge - FBST 6-PLC RD - 2966236

<https://www.phoenixcontact.com/de/produkte/2966236>

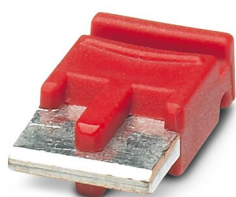

Single plug-in bridge, color: red

 Max. current carrying capacity: 6 A

Reversing load relay - PLC-PT-ELR W1/ 2-24DC

1069556

<https://www.phoenixcontact.com/de/produkte/1069556>

Single plug-in bridge

Single plug-in bridge - FBST 6-PLC BU - 2966812

<https://www.phoenixcontact.com/de/produkte/2966812>

Single plug-in bridge, color: blue

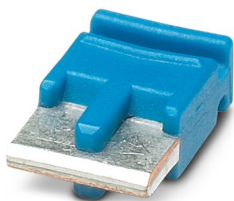

 Max. current carrying capacity: 6 A

Single plug-in bridge

Single plug-in bridge - FBST 6-PLC GY - 2966825

<https://www.phoenixcontact.com/de/produkte/2966825>

Single plug-in bridge, color: gray

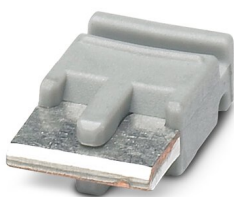

 Max. current carrying capacity: 6 A

Reversing load relay - PLC-PT-ELR W1/ 2-24DC



1069556

<https://www.phoenixcontact.com/de/produkte/1069556>

Single plug-in bridge

Single plug-in bridge - FBST 8-PLC GY - 2967688

<https://www.phoenixcontact.com/de/produkte/2967688>

Single plug-in bridge, color: gray



 Max. current carrying capacity: 6 A

DIN rail, unperforated

DIN rail, unperforated - NS 35/ 7,5 V2A UNPERF 2000MM - 0801377

<https://www.phoenixcontact.com/de/produkte/0801377>



DIN rail, unperforated, acc. to EN 60715, material: Stainless steel V2A, uncoated, Standard profile, color: silver, Pack of 25 (50 m)

Reversing load relay - PLC-PT-ELR W1/ 2-24DC



1069556

<https://www.phoenixcontact.com/de/produkte/1069556>

DIN rail perforated

DIN rail perforated - NS 35/ 7,5 PERF 2000MM - 0801733

<https://www.phoenixcontact.com/de/produkte/0801733>



DIN rail perforated, acc. to EN 60715, material: Steel, galvanized, passivated with a thick layer, Standard profile, color: silver, Pack of 25 (50 m)

DIN rail, unperforated

DIN rail, unperforated - NS 35/ 7,5 CU UNPERF 2000MM-VPE 10 - 0801762

<https://www.phoenixcontact.com/de/produkte/0801762>



DIN rail, unperforated, acc. to EN 60715, material: Copper, uncoated, Standard profile, color: copper-colored, Pack of 10 (20 m)

Reversing load relay - PLC-PT-ELR W1/ 2-24DC

1069556

<https://www.phoenixcontact.com/de/produkte/1069556>

DIN rail, unperforated

DIN rail, unperforated - NS 35/15 UNPERF 2000MM - 1201714

<https://www.phoenixcontact.com/de/produkte/1201714>



DIN rail, unperforated, similar to EN 60715, material: Steel, galvanized, passivated with a thick layer, Standard profile, color: silver, Pack of 25 (50 m)

DIN rail, unperforated

DIN rail, unperforated - NS 35/15 CU UNPERF 2000MM-VPE 10 - 1201895

<https://www.phoenixcontact.com/de/produkte/1201895>



DIN rail, unperforated, similar to EN 60715, material: Copper, uncoated, Standard profile, color: copper-colored, Pack of 10 (20 m)

Reversing load relay - PLC-PT-ELR W1/ 2-24DC



1069556

<https://www.phoenixcontact.com/de/produkte/1069556>

DIN rail, unperforated

DIN rail, unperforated - NS 35/15-2,3 UNPERF 2000MM-VPE 10 - 1201798

<https://www.phoenixcontact.com/de/produkte/1201798>



DIN rail, unperforated, acc. to EN 60715, material: Steel, galvanized, passivated with a thick layer, Standard profile 2.3 mm, color: silver, Pack of 10 (20 m)

DIN rail, unperforated

DIN rail, unperforated - NS 35/15 AL UNPERF 2000MM - 1201756

<https://www.phoenixcontact.com/de/produkte/1201756>



DIN rail, unperforated, similar to EN 60715, material: Aluminum, uncoated, Standard profile, color: silver

Reversing load relay - PLC-PT-ELR W1/ 2-24DC

1069556

<https://www.phoenixcontact.com/de/produkte/1069556>

DIN rail perforated

DIN rail perforated - NS 35/15 PERF 2000MM - 1201730

<https://www.phoenixcontact.com/de/produkte/1201730>



DIN rail perforated, similar to EN 60715, material: Steel, galvanized, passivated with a thick layer, Standard profile, color: silver, Pack of 25 (50 m)

DIN rail, unperforated

DIN rail, unperforated - NS 35/ 7,5 UNPERF 2000MM - 0801681

<https://www.phoenixcontact.com/de/produkte/0801681>



DIN rail, unperforated, acc. to EN 60715, material: Steel, galvanized, passivated with a thick layer, Standard profile, color: silver, Pack of 25 (50 m)

Reversing load relay - PLC-PT-ELR W1/ 2-24DC

1069556

<https://www.phoenixcontact.com/de/produkte/1069556>

Power terminal block

Power terminal block - PLC-ESK GY - 2966508

<https://www.phoenixcontact.com/de/produkte/2966508>



Power terminal block, for the input of up to four potentials, for mounting on NS 35/7.5

Separating plate

Separating plate - PLC-ATP BK - 2966841

<https://www.phoenixcontact.com/de/produkte/2966841>



Separating plate, 2 mm thick, required at the start and end of a PLC terminal strip. Furthermore, it is used for: visual separation of groups, safe isolation of different voltages of neighboring PLC relays in acc. with DIN VDE 0106-101, isolation

Reversing load relay - PLC-PT-ELR W1/ 2-24DC



1069556

<https://www.phoenixcontact.com/de/produkte/1069556>

Screwdriver

Screwdriver - SZF 1-0,6X3,5 - 1204517

<https://www.phoenixcontact.com/de/produkte/1204517>



Actuation tool, for ST terminal blocks, also suitable for use as a bladed screwdriver, size: 0.6 x 3.5 x 100 mm, 2-component grip, with non-slip grip

Phoenix Contact 2022 © - all rights reserved

<https://www.phoenixcontact.com>

PHOENIX CONTACT Deutschland GmbH

Flachsmarktstraße 8

D-32825 Blomberg

+49 52 35/3-1 20 00

info@phoenixcontact.de