

Energy Saving Lighting

Energy-saving Lighting 7W 220-240V 50/60Hz (corresponds 50W bulb)

with electronic fluorescent lamp ballast (EVG), integrated door position switch, On/Off switch, 2m connection cable 2x0,75mm²

Adhesive tape for assembly in plastic cabinets and metal cabinets, as well a fixing hole in 25mm Raster

Colour RAL 7035 structural colour.

Protective system: 2; IP20

Weight: 35 gr (without cable and lamp)

Approbation: CE, ENEC (European approbation), VDE and GS checked, EMV checked, corresp. RoHS.



With door position switch mounted on the lighting

LS07-K-SK 7W, Dim:146/85/67mm (L/W/H)

Alternatively with magnetic fixing system (pull-off approx 3,5KG)

LS07-K-SK-M20

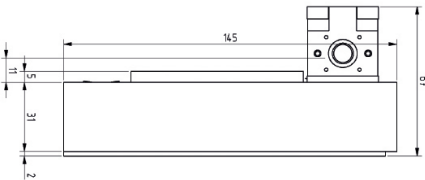

With net input and On/Off switch

LS07-K 7W, Dim:146/85/36mm (L/W/H)

Alternatively with magnetic fixing system (pull-off approx. 3,5KG)

LS07-K-M20

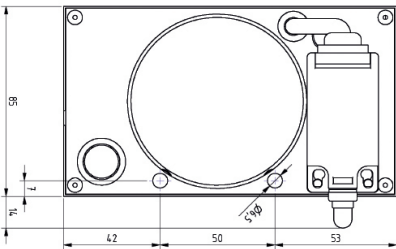

Energy-saving lighting with motion detector

(operating time approx. 7min, operating radius approx. 1,2m)

LS07-K-B 7W, Maße:146/85/41mm (L/W/H)

Alternatively with magnetic fixing system (pull-off approx. 3,5KG)

LS07-K-B-M20

Switch Cabinet Lighting 15/20, 220-240V 50/60Hz

The first easy-to-install switch cabinet lighting, which can be assembled and disassembled without tools, integrated door position switch (applicable for various switch cabinet types), mains connection and passage wiring, socket capacity 16A, On- /Off switch, EVG, Snap In assembly, with two fixing brackets in combination with a detent pin, the lamp can be assembled in a 25mm switch cabinet **Colour RAL 7035 structural colour.**

Protective system 1, IP20

Weight:363g

Approbation: CE, VDE, ENEC, EMV checked, corresp. RoHS



With door position switch mounted on the lighting
(applicable for various switch cabinet types)

LS15-SK 15W, Dim: 302/62/83 (L/W/H) suitable for switch cabinets as from 500mm width

LS20-SK 20W, Dim: 302/62/83 (L/W/H) suitable for switch cabinets as from 500mm width

Option

LS...M20

For assembly in metal cabinets you receive the lamps with magnetic vinyl.
pull-off approx.5kg