

PB500183



Cable-entry plate

- Designed to be installed inside the enclosures with open bottom part (version PLAZ or PLAZT).
- Polyester material reinforced with fibreglass, thickness 4 mm.
- Easy drilling in specific customised version.
- Delivered with the fixings required for installation.
- Incompatibility with: adapter plates, step slides, internal door and chassis for modular distribution.

For enclosure (mm)		Reference
Width (B)	Depth (C)	
500	320	NSYECPLAZ53
750	320	NSYECPLAZ73
1000	320	NSYECPLAZ103
1250	320	NSYECPLAZ123
500	420	NSYECPLAZ54
750	420	NSYECPLAZ74
1000	420	NSYECPLAZ104
1250	420	NSYECPLAZ124

Cable-entry plate (1-door enclosure)

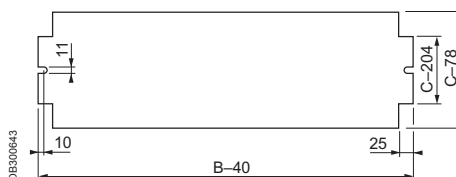

Cable-entry plate (2-door enclosure)

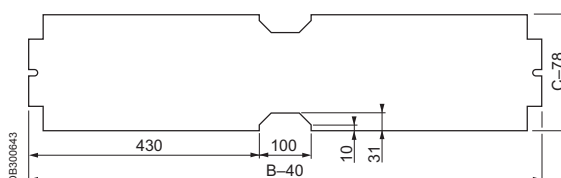

See also
the accessories

Cable management
Cable entries
page 435

Cable holding
page 454