





LV HRC FUSE LINK GL/GG WITH NON-INSULATED GRIP LUGS WITH FRONT INDICATOR SIZE 00, 35A, AC 500V/DC 250V

Similar to image

Technical data:

| | | |
|---|----|--|
| Current / for AC / rated value | A | 35 |
| Operating class of the fuse link | | gG |
| Size of the fallback-system / acc. to DIN EN 60269-1 | | NH00 |
| Supply voltage | | |
| • for AC / rated value | V | 500 |
| • for DC | V | 250 |
| Switching capacity current | | |
| • in accordance with IEC 60947-2 / rated value | kA | 120 |
| • with DC / in accordance with IEC 60947-2 / rated value | kA | 25 |
| Design of an identification indicator | | Front indicators |
| type of the assembly | | Non-insulated grip lugs |
| Protection class IP | | IP20, with connected conductors |
| Climatic class | | -20 to +50 at 95% relative humidity |
| Ambient temperature | | |
| • minimum | °C | -5 |
| • maximum | °C | 40 |
| Product description | | Using screw adapter or adapter sleeves |

Certificates/approvals:

| General Product Approval | | | Declaration of Conformity | Test Certificates | Shipping Approval |
|---|---|--|---|--|---|
|  GOST |  KEMA |  VDE |  EG-Konf. | Special Test Certificate |  GL |

other

[Environmental Confirmations](#)

Further information:

Information- and Downloadcenter (Catalogs, Brochures,...)

<http://www.siemens.com/lowvoltage/catalogs>

Industry Mall (Online ordering system)

<http://www.siemens.com/lowvoltage/mall>

Service&Support (Manuals, Certificates, Characteristics, FAQs,...)

<http://support.automation.siemens.com/WW/view/en/3NA3814-7/all>

Image database (product images, 2D dimension drawings, 3D models, device circuit diagrams, ...)

http://www.automation.siemens.com/bilddb/cax_en.aspx?mlfb=3NA3814-7

CAX-Online-Generator

<http://www.siemens.com/cax>

Tender specifications

[Datanorm GAEB81](#) [GAEB83](#) [RTF](#) [TXT](#)

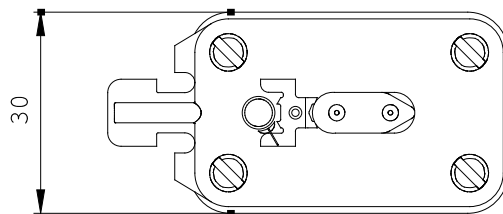
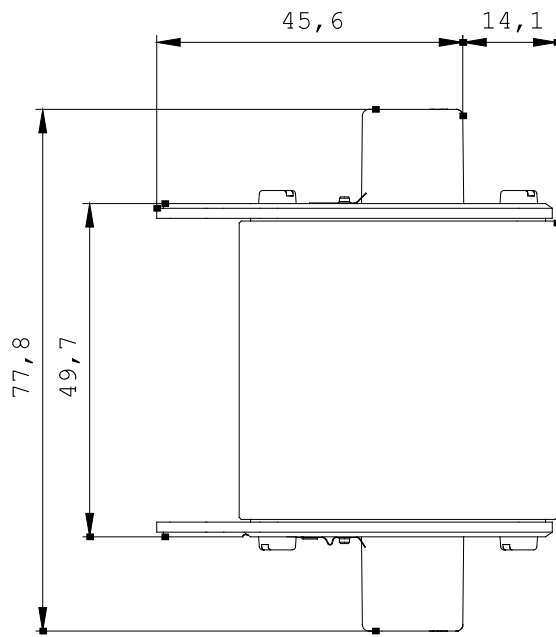

last change:

Jul 1, 2013