



CONTACTOR RELAY, 3NO+1NC AC 230V,
50/60 HZ, SZ S00, SCREW TERMINAL

General technical data:

Product brand name		SIRIUS
Product designation		contactor relay
Size of the contactor		S00
Protection class IP / frontal/front side		IP20
Degree of pollution		3
Insulation voltage / with degree of pollution 3 / rated value	V	690
Installation altitude / at a height over sea level / maximum	m	2,000
Ambient temperature		
• during transport	°C	-55 ... 80
• during storage	°C	-55 ... 80
• during the operating phase	°C	-25 ... 60
Resistance against shock		10g / 5 ms and 5g / 10 ms
Impulse voltage resistance / rated value	kV	6
Item designation		
• according to DIN 40719 extendable after IEC 204-2 / according to IEC 750		K
• according to DIN EN 61346-2		K
Mechanical operating cycles as operating time		
• of the contactor / typical		30,000,000

- of the contactor with added auxiliary switch block / typical
- of the contactor with added electronics-compatible auxiliary switch block / typical

10,000,000

10,000,000

Control circuit:

Type of voltage / of the controlled supply voltage		AC
Control supply voltage frequency		
• 1 / rated value	Hz	50
• 2 / rated value	Hz	60
Control supply voltage / 1		
• at 50 Hz / for AC / rated value	V	230
• at 60 Hz / for AC / rated value	V	230
Operating range factor control supply voltage rated value / of the solenoid		
• at 50 Hz / for AC		0.8 ... 1.1
• at 60 Hz / for AC		0.85 ... 1.1
Apparent pull-in power / of the solenoid / for AC	V·A	37
Apparent holding power / of the solenoid / for AC	V·A	5.7
Power factor inductive		
• at pull-in power of the coil		0.8
• at holding power of the coil		0.25

Auxiliary circuit:

Product extension / auxiliary switch		Yes
Identification number and letter for switching elements		31 E
Contact reliability / of the auxiliary contacts		1 faulty switching per 100 million (17 V, 1 mA)
Number of NC contacts / for auxiliary contact		1
• instantaneous switching		1
• delayed switching		0
• asynchronous switching		0
• lagging switching		0
Number of NO contacts / for auxiliary contact		3
• instantaneous switching		3
• delayed switching		0
• asynchronous switching		0
• leading switching		0
Number of changeover contacts		
• for auxiliary contact		0
Operating current / of the auxiliary contacts		
• at AC-12 / maximum	A	10
• at AC-15		

- at 230 V
- at 400 V
- at 500 V
- at 690 V
- with 1 current path
 - at DC-12
 - at 24 V
 - at 110 V
 - at 220 V
 - at DC-13
 - at 24 V
 - at 110 V
 - at 220 V

A	10
A	3
A	2
A	1
A	6
A	3
A	1
A	6
A	1
A	0.3

Short-circuit:

Design of the fuse link / for short-circuit protection of the auxiliary switch

- required

Fuse gL/gG: 10 A, miniature circuit breaker C 6 A (short-circuit current $I_k < 400$ A)

Installation/mounting/dimensions:

Built in orientation

vertical

Type of fixing/fixation

screw and snap-on mounting onto 35 mm standard mounting rail

Width

mm 45

Height

mm 57.5

Depth

mm 72

Distance, to be maintained, to the ranks assembly

• forwards	mm	0
• backwards	mm	0
• upwards	mm	0
• downwards	mm	0
• sideways	mm	0

Distance, to be maintained, to earthed part

• forwards	mm	6
• backwards	mm	0
• upwards	mm	6
• downwards	mm	6
• sideways	mm	6

Distance, to be maintained, conductive elements

• forwards	mm	0
• backwards	mm	0

- upwards
- downwards
- sideways

mm	0
mm	0
mm	0

Connections:

Design of the electrical connection

- for auxiliary and control current circuit

screw-type terminals

Type of connectable conductor cross section

- for auxiliary contacts
 - solid
 - finely stranded
 - with wire end processing
- for AWG conductors / for auxiliary contacts

2x (0.5 ... 1.5 mm²), 2x (0.75 ... 2.5 mm²), 2x 4 mm²

2x (0.5 ... 1.5 mm²), 2x (0.75 ... 2.5 mm²)

2x (20 ... 16), 2x (18 ... 14), 2x 12

Certificates/approvals:

Verification of suitability

CE / UL / CSA / CCC

Safety:

B10 value / with high demand rate

- according to SN 31920

1,000,000

Proportion of dangerous failures

- with low demand rate / according to SN 31920
- with high demand rate / according to SN 31920

% 40

% 75

Failure rate (FIT value) / with low demand rate

- according to SN 31920

FIT 100

T1 value / for proof test interval or service life

- according to IEC 61508

a 10

Protection against electrical shock

finger-safe

Further information:

Information- and Downloadcenter (Catalogs, Brochures,...)

<http://www.siemens.com/industrial-controls/catalogs>

Global Industry Mall (Online ordering system)

<http://www.siemens.com/industrial-controls/mall>

Service&Support (Manuals, Certificates, Characteristics, FAQs,...)

<http://support.automation.siemens.com/WW/view/en/3RH2131-1AP00/all>

Image database (product images, 2D dimension drawings, 3D models, device circuit diagrams, ...)

http://www.automation.siemens.com/bilddb/cax_en.aspx?mlfb=3RH2131-1AP00

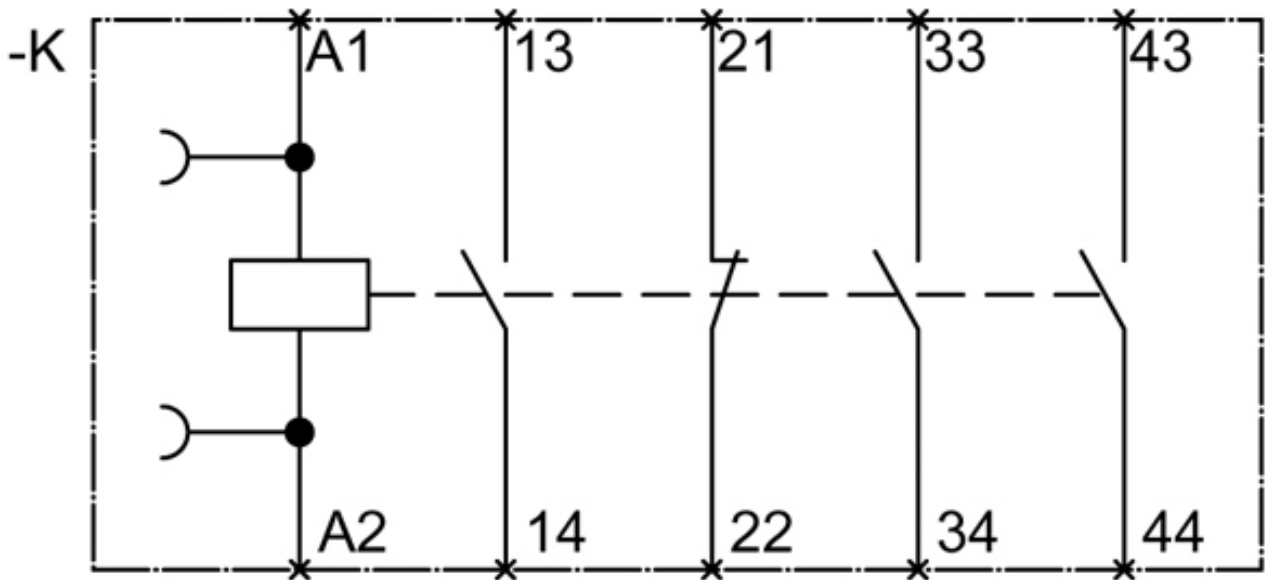
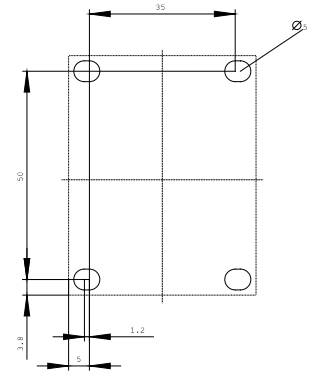
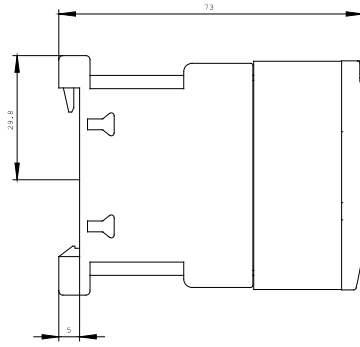
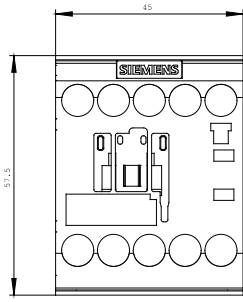

last change:

Aug 23, 2010