



AS-INTERFACE SLIMLINE MODULE S22.5, EARTH FAULT MONITORING, IP20, 1 X 1 INPUT, REMOTE RESET, 2 X SIGNAL OUTPUT, RELAY, 1A DC12 1A (2A MAX.) DC13 500MA (24V) CAGE-CLAMP, MODULE WIDTH 22.5 MM, NO AS-I ADDRESS REQUIRED AS-INTERFACE MONITORING ONLY

General technical data:

Design of the product		ground-fault detection modules - modules with special functions
Product function		
<ul style="list-style-type: none"> • Ground fault detection • counter • Overvoltage detection 		<p>Yes</p> <p>No</p> <p>No</p>
Protocol is supported AS-interface protocol		Yes
Type of electrical connection of the inputs and outputs		spring-loaded terminals
AS interface total current input max	mA	40
Earth fault		10% U _{as-i} ≤ U _{gnd} ≤ 90% U _{as-i}
Addressing		the module does not need its own AS-Interface address
Signal range		
<ul style="list-style-type: none"> • low signal lin max • high signal — U_{in} min — lin min 	<p>mA</p> <p>V</p> <p>mA</p>	<p>1.5</p> <p>10</p> <p>6</p>

Current carrying capacity		
• DC-12	A	1
• DC-13		
— 24 V	mA	500
— 48 V	mA	200
Operating cycles DC-12		2 000 000
Rated operational voltage DC	V	24 ... 48
Rated temperature	°C	25
AS interface Connection Polarity reversal protection		built-in
Note 1		If repeaters are used, a ground fault detection module must be used for each AS-Interface segment (number of AS-Interface power supply units = number of ground fault detection modules)
Note 2		Uaux should be protected by a 2 A slow fuse. The endurance of the relay can be increased if inductive loads are connected using freewheel diodes.
Equipment marking acc. to DIN 40719 extended according to IEC 204-2 acc. to IEC 750		A
Equipment marking acc. to DIN EN 61346-2		K

Ambient conditions:

Ambient temperature		
• during operation	°C	-25 ... +70
• during storage	°C	-40 ... +85
Protection class IP		IP20

Mechanical data:

Width	mm	22.5
Height	mm	103
Depth	mm	86
Mounting type		standard rail mounting/wall mounting
Conductor cross-section		
• solid		2 x (0.25 - 1.5) mm ²
• finely stranded		
— with end sleeve		2 x (0,25 - 1) mm ²
— without end sleeve		2 x (0.25 - 1.5) mm ²
• AWG solid or stranded		AWG 2 x (24 - 16) mm ²

Certificates/ approvals:

General Product Approval	Declaration of Conformity	Shipping Approval
--------------------------	---------------------------	-------------------



Shipping Approval	other
-------------------	-------



[Confirmation](#)

[Miscellaneous](#)

Further information

Information- and Downloadcenter (Catalogs, Brochures,...)

<http://www.siemens.com/industrial-controls/catalogs>

Industry Mall (Online ordering system)

<http://www.siemens.com/industrymall>

Cax online generator

<http://support.automation.siemens.com/WW/CAXorder/default.aspx?lang=en&mlfb=3RK1408-8KG00-0AA2>

Service&Support (Manuals, Certificates, Characteristics, FAQs,...)

<https://support.industry.siemens.com/cs/ww/en/ps/3RK1408-8KG00-0AA2>

Image database (product images, 2D dimension drawings, 3D models, device circuit diagrams, EPLAN macros, ...)

http://www.automation.siemens.com/bilddb/cax_de.aspx?mlfb=3RK1408-8KG00-0AA2&lang=en

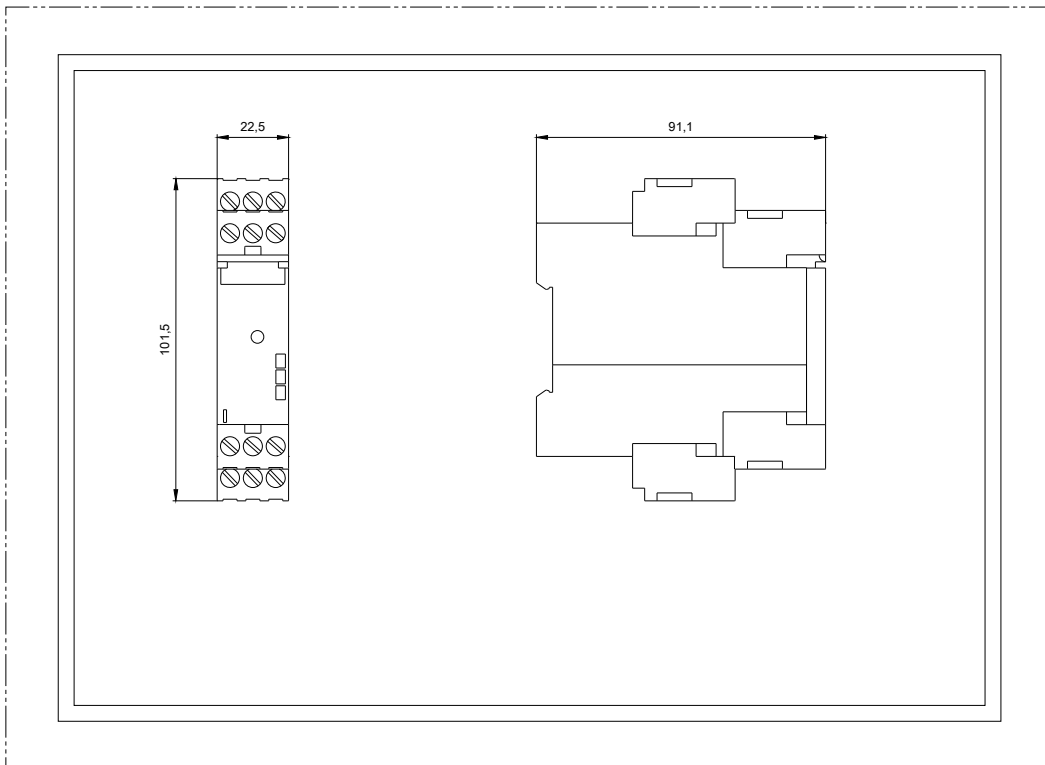

last modified:

08/02/2017