

PARALLEL CONNECTION W/O TERMINAL,
3-POLE FOR 3RT101.,
SCREW CONNECTION (REPLACEMENT FOR 3TX4490-
2C, FOR 3TF2, 3TK2)

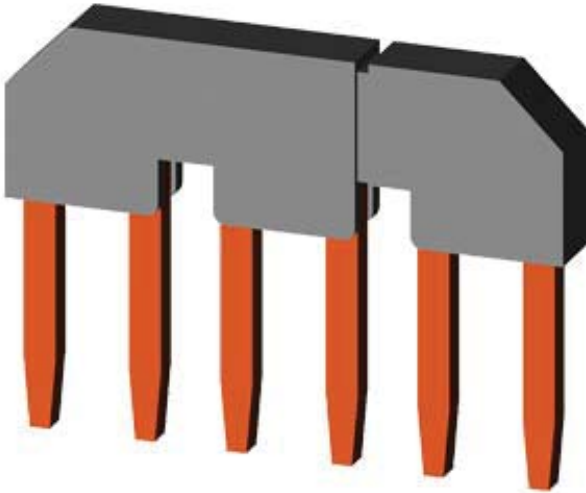

General technical data:		
product brand name		SIRIUS
product designation		Connection jumper
Size of the contactor		S00
Design of the product		Parallel switching connection for contactors S00
Acceptability for application		3RT101, 3TF20
Installation/mounting/dimensions:		
Type of mounting		screw fixing
Width	mm	24.4
Height	mm	18
Depth	mm	3
Certificates/approvals:		

General Product Approval	Functional Safety / Safety of Machinery	Declaration of Conformity	Test Certificates
---------------------------------	--	----------------------------------	--------------------------



[Type Examination](#)



EG-Konf.

[Special Test Certificate](#)

Shipping Approval



Shipping Approval



other

[Confirmation](#)



VDE

[Declaration of Conformity](#)

[other](#)

[Environmental Confirmations](#)

Further information:

Information- and Downloadcenter (Catalogs, Brochures,...)

<http://www.siemens.com/industrial-controls/catalogs>

Industry Mall (Online ordering system)

<http://www.siemens.com/industrial-controls/mall>

CAX-Online-Generator

<http://www.siemens.com/cax>

Service&Support (Manuals, Certificates, Characteristics, FAQs,...)

<http://support.automation.siemens.com/WW/view/en/3RT1916-4BA31/all>

Image database (product images, 2D dimension drawings, 3D models, device circuit diagrams, ...)

http://www.automation.siemens.com/bilddb/cax_en.aspx?mlfb=3RT1916-4BA31

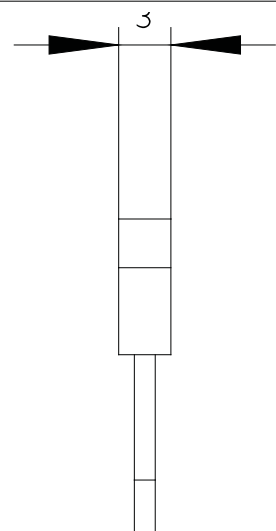
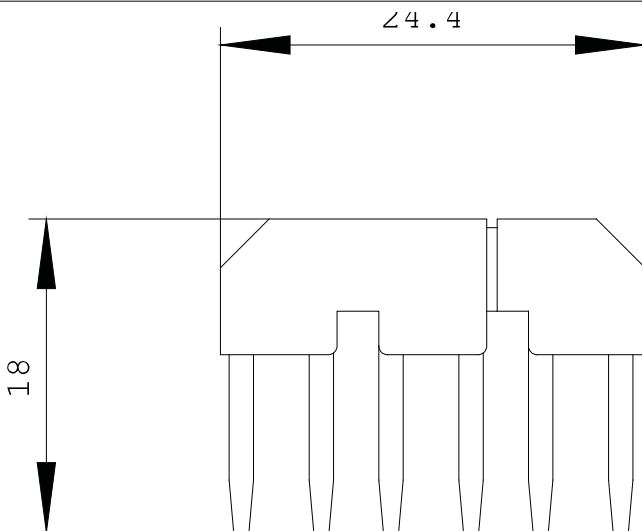

last change:

Oct 22, 2012