



CIRCUIT-BREAKER, SIZE S0,
FOR MOTOR PROTECTION, CLASS 10,
A REL.9...12,5 A, N REL.163 A,
SCREW CONNECTION,
STANDARD BREAKING CAPACITY W. TRANSV. AUX.
SWITCH 1NO/1NC

General technical data:

Product brand name		SIRIUS
Product designation		circuit breaker
Size of the circuit-breaker		S0
Trip class		CLASS 10
Degree of pollution		3
Altitude of installation site / at a height over sea level / maximum	m	2,000
Protection class IP / frontal/front side		IP20
Ambient temperature		
• during storage	°C	-50 ... 80
• during the operating phase	°C	-20 ... 70
• during transport	°C	80 ... -50
Resistance against shock		25g / 11 ms
Insulation voltage / rated value	V	690
Impulse voltage resistance / rated value	kV	6
Real loss power / total / typical	W	7
Item designation		
• according to DIN 40719 extendable after IEC 204-2 / according to IEC 750		Q
• according to DIN EN 61346-2		Q

Mechanical switching cycle as operating period / of the main contacts / typical		100,000
Design of the auxiliary switch		transverse
Type of the driving mechanism / Motor drive		No
design of the operating mechanism		selector switch
Product function		
• Overload protection		Yes
• Phase disturbance recognition		Yes
Product component		
• auxiliary switch		Yes
• Undervoltage release mechanism		No
• trip indicator		Yes
Product extension / optional / Motor drive		No

Main circuit:

Number of poles / for main current circuit		3
Type of voltage		AC/DC
Operating voltage / at 3 AC / rated value / maximum	V	690
Operating current / at AC-3 / at 400 V / rated value	A	12.5
Service power / at AC-3		
• at 400 V / rated value	kW	5.5
Switching frequency / at AC-3 / according to IEC 60947-6-2 / maximum	1/h	15
Arrangement of electrical connectors / for main current circuit		front side
Adjustable response current		
• of the non-delayed short-circuit release	A	163 ... 163
Adjustable response current		
• of the current-dependent overload release	A	9 ... 12.5
Continuous current / rated value	A	12.5
Product extension / auxiliary switch		Yes

Auxiliary circuit:

Number of NC contacts / for auxiliary contacts / instantaneous switching		1
Number of NO contacts / for auxiliary contacts / instantaneous switching		1
Number of change-over switches / for auxiliary contact		0
Operating current / of the auxiliary contacts		
• at AC-15		
• at 24 V	A	2
• at 230 V	A	0.5
• at DC-13		

- at 24 V
- at 60 V

A	1
A	0.15

Inputs/ Outputs:

Number of digital inputs

0

Short-circuit:

Breaking capacity limit short-circuit current (I_{cu})

- at 400 V / rated value
- at 500 V / rated value
- at 690 V / rated value

kA	100
kA	42
kA	6

design of the electrical connection / for auxiliary and control current circuit

screw-type terminals

Design of the overcurrent release and short-circuit release

thermomagnetic

Installation/mounting/dimensions:

built in orientation

any

Type of fixing/fixation

screw and snap-on mounting onto 35 mm standard mounting rail according to DIN EN 50022

Width

mm 45

Height

mm 97

Depth

mm 96

distance, to be maintained, to the ranks assembly

- backwards
- sideways

mm	0
mm	0

Product function / removable terminal for auxiliary and control circuit

No

Connections:

Design of the electrical connection

- for main current circuit

screw-type terminals

Type of the connectable conductor cross-section

- for main contacts
 - unifilar
 - stranded wire
 - stranded wire
 - with conductor end processing
- at AWG-conductors / for main contacts
- for auxiliary contacts
 - solid
 - finely stranded / with wire end processing
- for AWG conductors / for auxiliary contacts

2x (1 ... 2.5 mm ²), 2x (2.5 ... 6 mm ²)
2x (1 ... 2,5 mm ²), 2x (2,5 ... 6 mm ²)
2x (1 ... 2.5 mm ²), 2x (2.5 ... 6 mm ²)
2x (14 ... 10)
2x (0.5 ... 1.5 mm ²), 2x (0.75 ... 2.5 mm ²)
2x (0.5 ... 1.5 mm ²), 2x (0.75 ... 2.5 mm ²)
2x (18 ... 14)

Conductor cross section that can be connected / for main contacts		
• unifilar	mm ²	1 ... 6
• stranded wire	mm ²	1 ... 6
• stranded wire		
• with conductor end processing	mm ²	1 ... 6
AWG number / as coded connectable conductor cross-section		
• for main contacts		14 ... 10
conductor cross section that can be connected / for auxiliary contact		
• unifilar	mm ²	0.5 ... 2.5
• stranded wire		
• with conductor end processing	mm ²	0.5 ... 2.5
AWG number / as coded connectable conductor cross-section		
• for auxiliary contact		18 ... 14

Safety:

Protection against electrical shock

finger-safe

Further information:

Information- and Downloadcenter (Catalogs, Brochures,...)

<http://www.siemens.com/industrial-controls/catalogs>

Global Industry Mall (Online ordering system)

<http://www.siemens.com/industrial-controls/mall>

Service&Support (Manuals, Certificates, Characteristics, FAQs,...)

<http://support.automation.siemens.com/WW/view/en/3RV1021-1KA15/all>

Image database (product images, 2D dimension drawings, 3D models, device circuit diagrams, ...)

http://www.automation.siemens.com/bilddb/cax_en.aspx?mlfb=3RV1021-1KA15

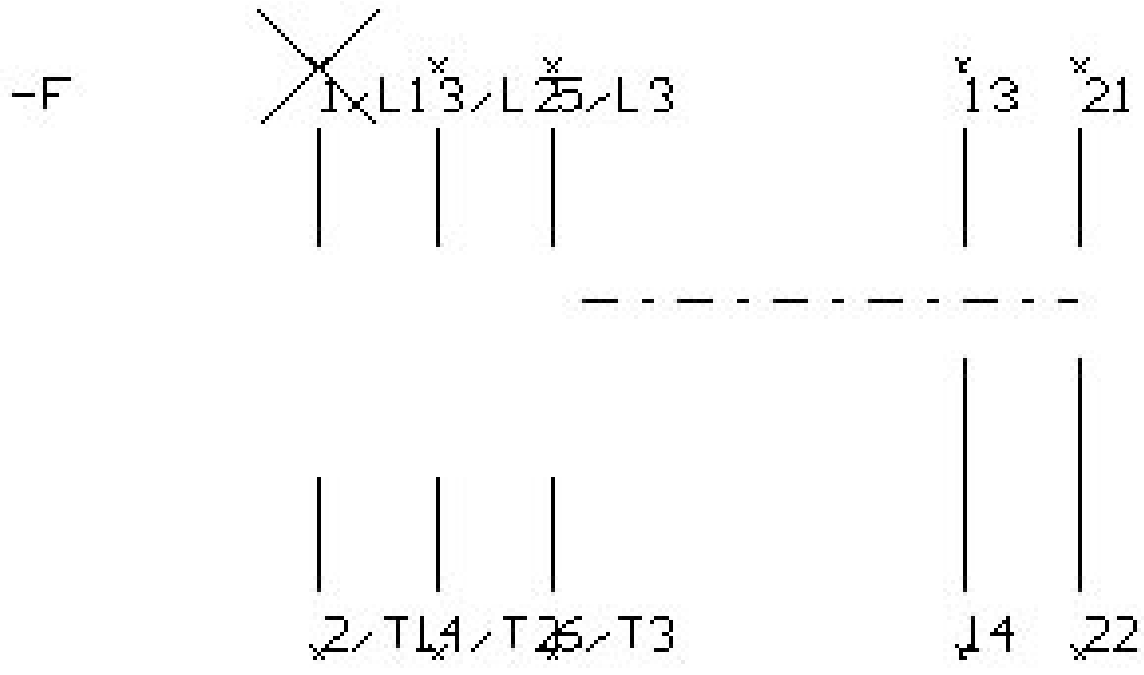
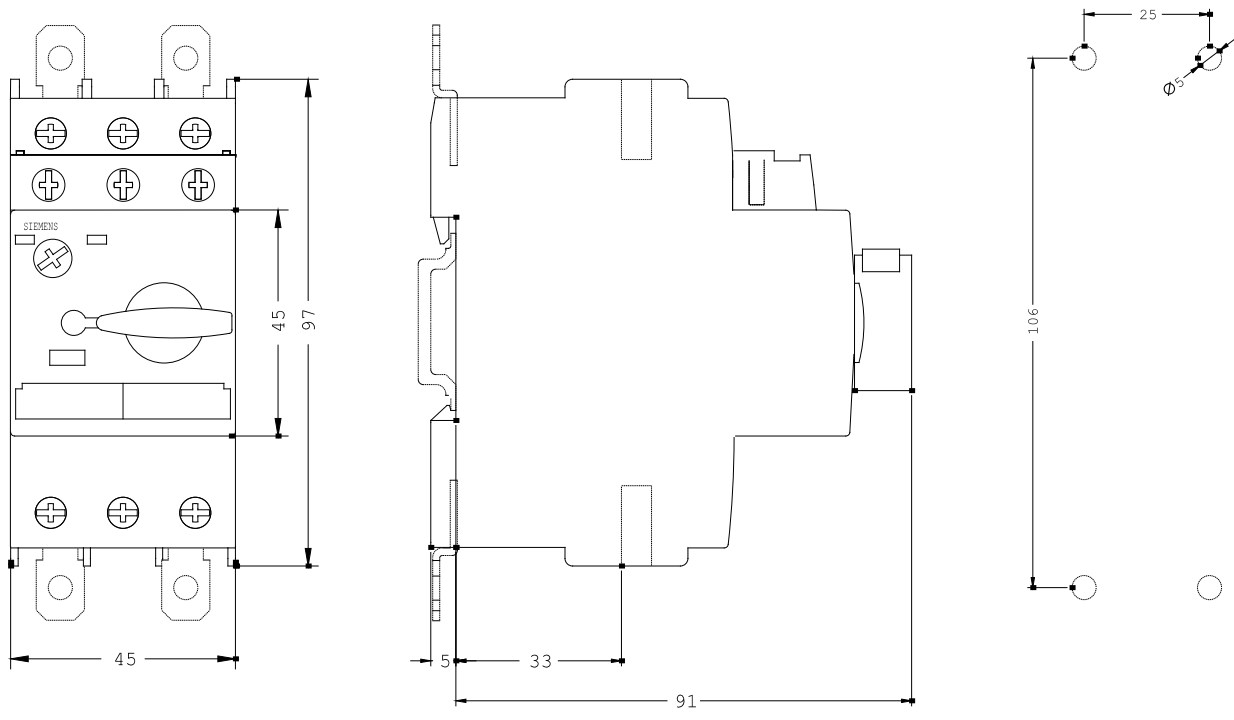

last change:

Jun 14, 2010