

CIRCUIT-BREAKER,  
0.55...0.8 A N-RELEASE 16 A, SIZE S0,  
TRANSFORMER PROTECTION, CL. 10,  
SCREW CONNECTION STANDARD BREAKING  
CAPACITY

General technical data:		
<b>Product brand name</b>		SIRIUS
<b>Product designation</b>		circuit breaker
<b>Size of the circuit-breaker</b>		S0
<b>Trip class</b>		CLASS 10
<b>Degree of pollution</b>		3
<b>Altitude of installation site / at a height over sea level / maximum</b>	m	2,000
<b>Protection class IP / frontal/front side</b>		IP20
<b>Ambient temperature</b>		
• during storage	°C	-50 ... 80
• during the operating phase	°C	-20 ... 70
• during transport	°C	80 ... -50
<b>Resistance against shock</b>		25g / 11 ms
<b>Insulation voltage / rated value</b>	V	690
<b>Impulse voltage resistance / rated value</b>	kV	6
<b>Real loss power / total / typical</b>	W	6
<b>Item designation</b>		
• according to DIN 40719 extendable after IEC 204-2 / according to IEC 750		Q
• according to DIN EN 61346-2		Q
<b>Mechanical switching cycle as operating period / of the main contacts / typical</b>		100,000
<b>Type of the driving mechanism / Motor drive</b>		No
<b>design of the operating mechanism</b>		selector switch
<b>Product function</b>		
• Overload protection		Yes
• Phase disturbance recognition		Yes
<b>Product component</b>		
• auxiliary switch		No
• Undervoltage release mechanism		No

• trip indicator		No
Product extension / optional / Motor drive		No

#### Main circuit:

Number of poles / for main current circuit		3
Type of voltage		AC/DC
Operating voltage / at 3 AC / rated value / maximum	V	690
Operating current / at AC-3 / at 400 V / rated value	A	0.8
Switching frequency / at AC-3 / according to IEC 60947-6-2 / maximum	1/h	15
Arrangement of electrical connectors / for main current circuit		front side
Adjustable response current		
• of the non-delayed short-circuit release	A	16 ... 16
Adjustable response current		
• of the current-dependent overload release	A	0.55 ... 0.8
Continuous current / rated value	A	0.8
Product extension / auxiliary switch		Yes

#### Auxiliary circuit:

Number of NC contacts / for auxiliary contacts / instantaneous switching		0
Number of NO contacts / for auxiliary contacts / instantaneous switching		0
Number of change-over switches / for auxiliary contact		0

#### Inputs/ Outputs:

Number of digital inputs		0
--------------------------	--	---

#### Short-circuit:

Breaking capacity limit short-circuit current (I <sub>cu</sub> )		
• at 400 V / rated value	kA	100
• at 500 V / rated value	kA	100
• at 690 V / rated value	kA	100
Design of the overcurrent release and short-circuit release		thermomagnetic

#### Installation/mounting/dimensions:

built in orientation		any
Type of fixing/fixation		screw and snap-on mounting onto 35 mm standard mounting rail according to DIN EN 50022
Width	mm	45
Height	mm	97
Depth	mm	96
distance, to be maintained, to the ranks assembly		

• backwards	mm	0
• sideways	mm	0
<b>Product function / removable terminal for auxiliary and control circuit</b>		No

<b>Connections:</b>		
<b>Design of the electrical connection</b>		
• for main current circuit		screw-type terminals
<b>Type of the connectable conductor cross-section</b>		
• for main contacts		
• unifilar		2x (1 ... 2.5 mm <sup>2</sup> ), 2x (2.5 ... 6 mm <sup>2</sup> )
• stranded wire		2x (1 ... 2,5 mm <sup>2</sup> ), 2x (2,5 ... 6 mm <sup>2</sup> )
• stranded wire		
• with conductor end processing		2x (1 ... 2.5 mm <sup>2</sup> ), 2x (2.5 ... 6 mm <sup>2</sup> )
• at AWG-conductors / for main contacts		2x (14 ... 10)
<b>Conductor cross section that can be connected / for main contacts</b>		
• unifilar	mm <sup>2</sup>	1 ... 6
• stranded wire	mm <sup>2</sup>	1 ... 6
• stranded wire		
• with conductor end processing	mm <sup>2</sup>	1 ... 6
<b>AWG number / as coded connectable conductor cross-section</b>		
• for main contacts		14 ... 10

<b>Safety:</b>		
<b>Protection against electrical shock</b>		finger-safe

<b>Further information:</b>		
<b>Information- and Downloadcenter (Catalogs, Brochures,...)</b>		
<a href="http://www.siemens.com/industrial-controls/catalogs">http://www.siemens.com/industrial-controls/catalogs</a>		
<b>Global Industry Mall (Online ordering system)</b>		
<a href="http://www.siemens.com/industrial-controls/mall">http://www.siemens.com/industrial-controls/mall</a>		
<b>Service&amp;Support (Manuals, Certificates, Characteristics, FAQs,...)</b>		
<a href="http://support.automation.siemens.com/WW/view/en/3RV1421-0HA10/all">http://support.automation.siemens.com/WW/view/en/3RV1421-0HA10/all</a>		
<b>Image database (product images, 2D dimension drawings, 3D models, device circuit diagrams, ...)</b>		
<a href="http://www.automation.siemens.com/bilddb/cax_en.aspx?mlfb=3RV1421-0HA10">http://www.automation.siemens.com/bilddb/cax_en.aspx?mlfb=3RV1421-0HA10</a>		

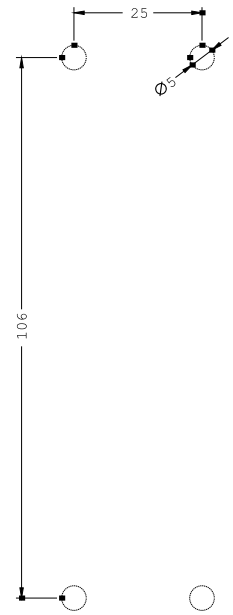
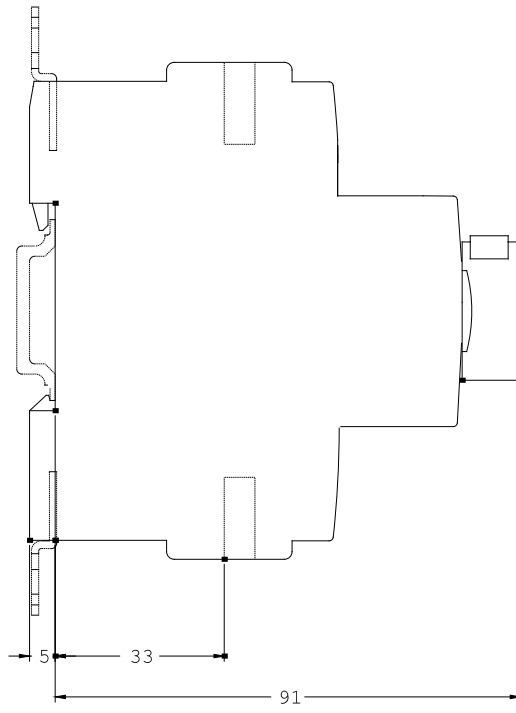
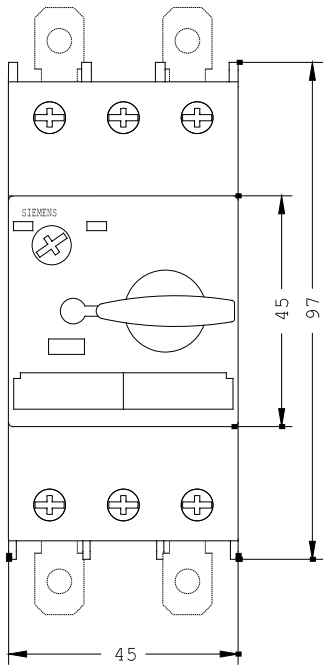

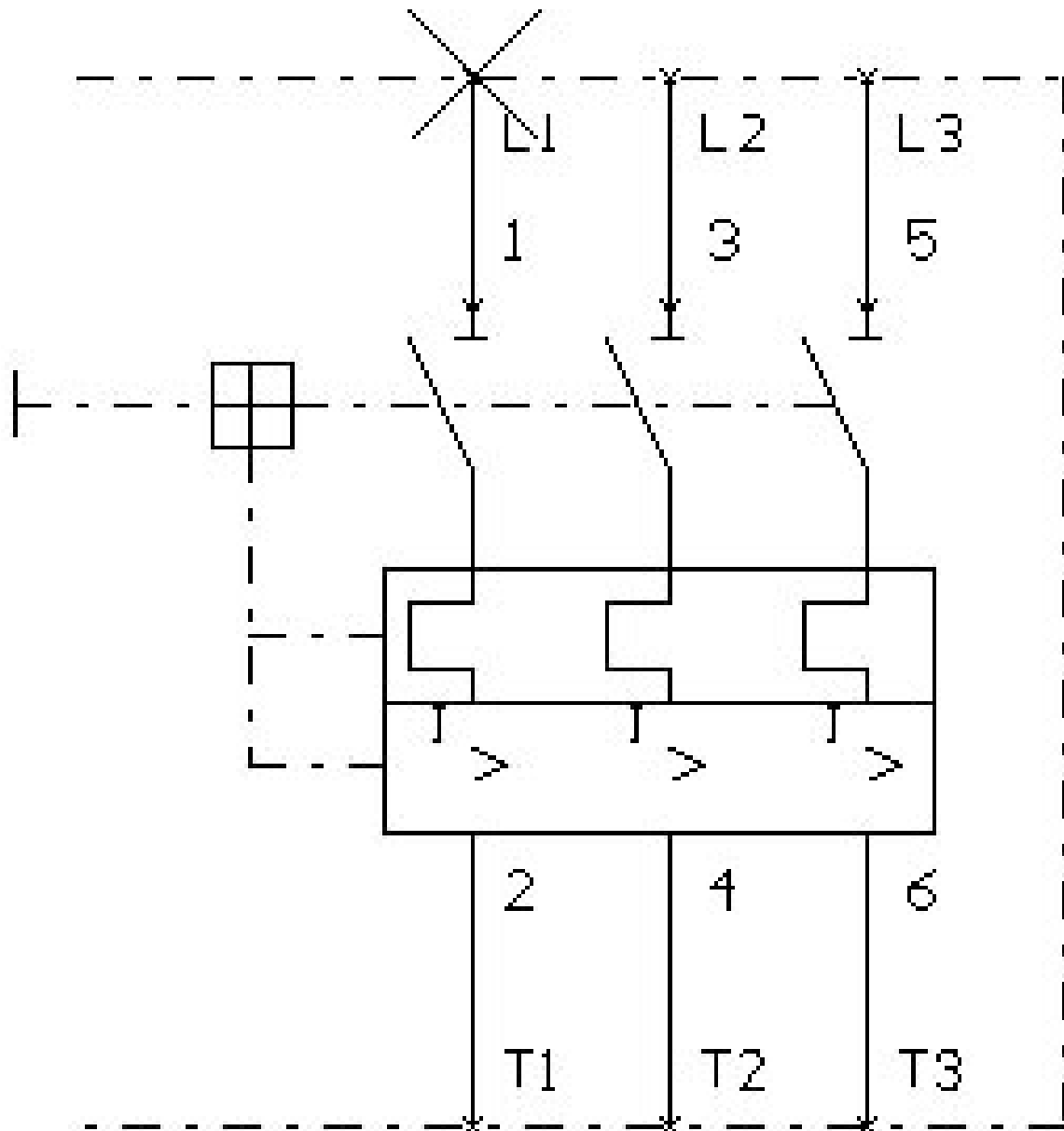

NSBO\_00008b

last change:

Jun 14, 2010