

communication module PROFINET standard



Product brand name	SIRIUS
Product category	Communication modules
Product designation	Communication module
Design of the product	PROFINET Standard
Manufacturer's article number	
• of soft starter	3RW50
• of soft starter	3RW51
• of soft starter	3RW52
• of soft starter	3RW55

General technical data	
Protection class IP	IP20
Reference code acc. to DIN EN 81346-2	A

Installation/ mounting/ dimensions	
Mounting position	any
Mounting type	screw fixing
Height	126 mm
Width	28 mm
Depth	82 mm

Installation altitude at height above sea level maximum	5 000 m; Derating as of 1000 m, see catalog
Weight without packaging	0.1 kg

Ambient conditions

Environmental category

- during operation acc. to IEC 60721
- during storage acc. to IEC 60721
- during transport acc. to IEC 60721

3K6 (no ice formation, only occasional condensation), 3C3 (no salt mist), 3S2 (sand must not get into the devices), 3M6
 1K6 (only occasional condensation), 1C2 (no salt mist), 1S2 (sand must not get inside the devices), 1M4
 2K2, 2C1, 2S1, 2M2 (max. height of fall 0.8 m)

Certificates/ approvals

General Product Approval

Declaration of Conformity



[Miscellaneous](#)

Test Certificates

Marine / Shipping

other

[Type Test Certificates/Test Report](#)



[Confirmation](#)

other

[PROFINET-Certification](#)

Further information

Information- and Downloadcenter (Catalogs, Brochures,...)

<https://www.siemens.com/ic10>

Industry Mall (Online ordering system)

<https://mall.industry.siemens.com/mall/en/en/Catalog/product?mlfb=3RW5980-0CS00>

Cax online generator

<http://support.automation.siemens.com/WW/CAXorder/default.aspx?lang=en&mlfb=3RW5980-0CS00>

Service&Support (Manuals, Certificates, Characteristics, FAQs,...)

<https://support.industry.siemens.com/cs/ww/en/ps/3RW5980-0CS00>

Image database (product images, 2D dimension drawings, 3D models, device circuit diagrams, EPLAN macros, ...)

http://www.automation.siemens.com/bilddb/cax_de.aspx?mlfb=3RW5980-0CS00&lang=en

Characteristic: Tripping characteristics, I^t, Let-through current

<https://support.industry.siemens.com/cs/ww/en/ps/3RW5980-0CS00/char>

Characteristic: Installation altitude

<http://www.automation.siemens.com/bilddb/index.aspx?view=Search&mlfb=3RW5980-0CS00&objecttype=14&gridview=view1>

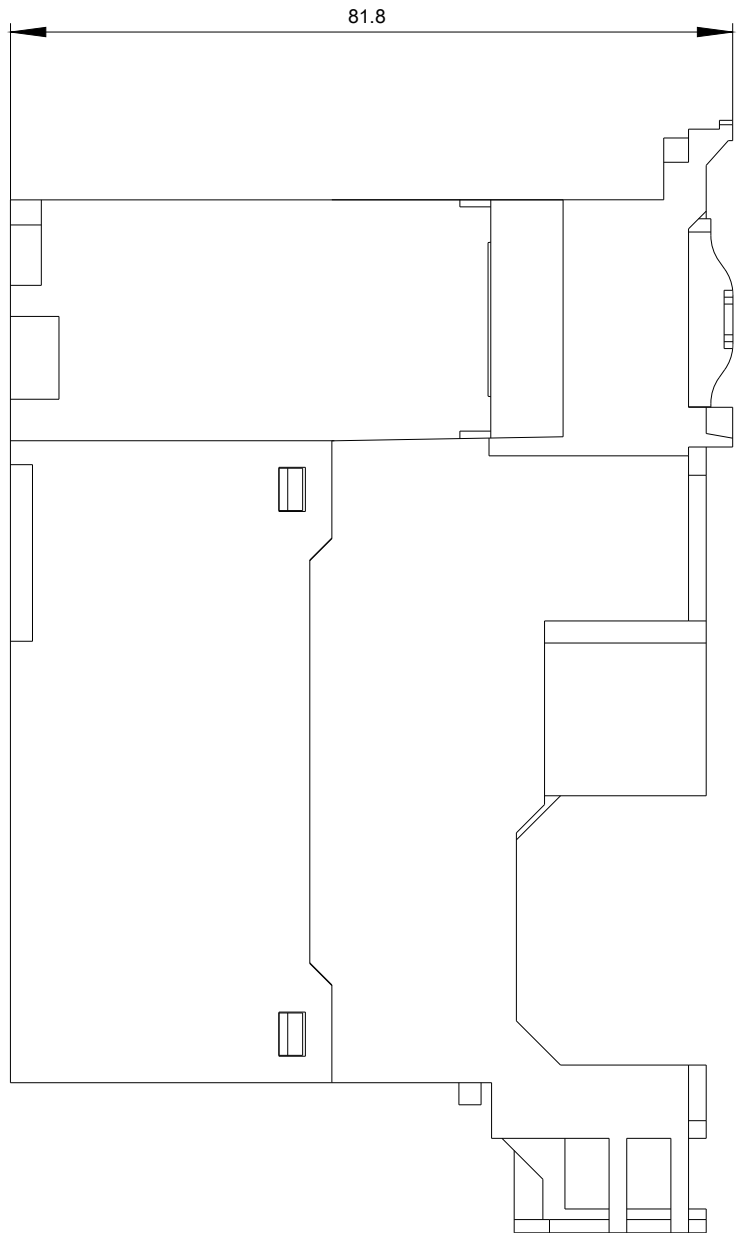
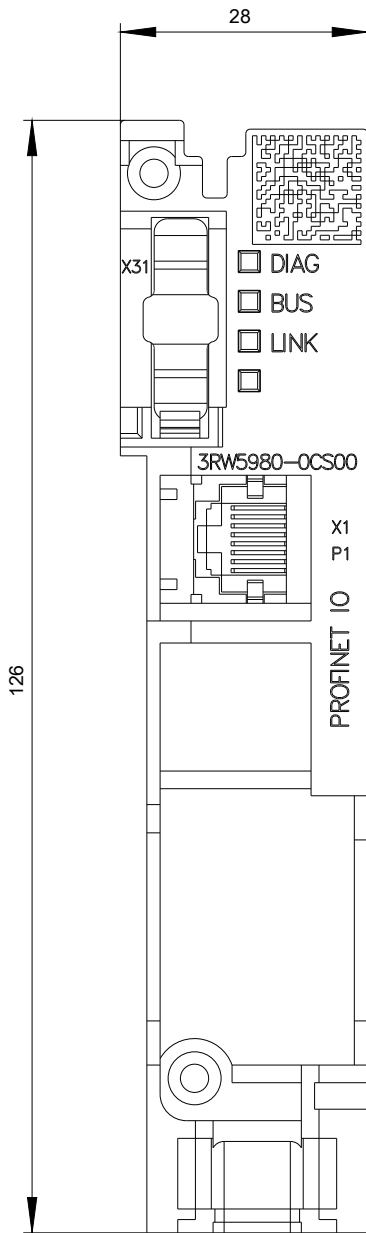

-A

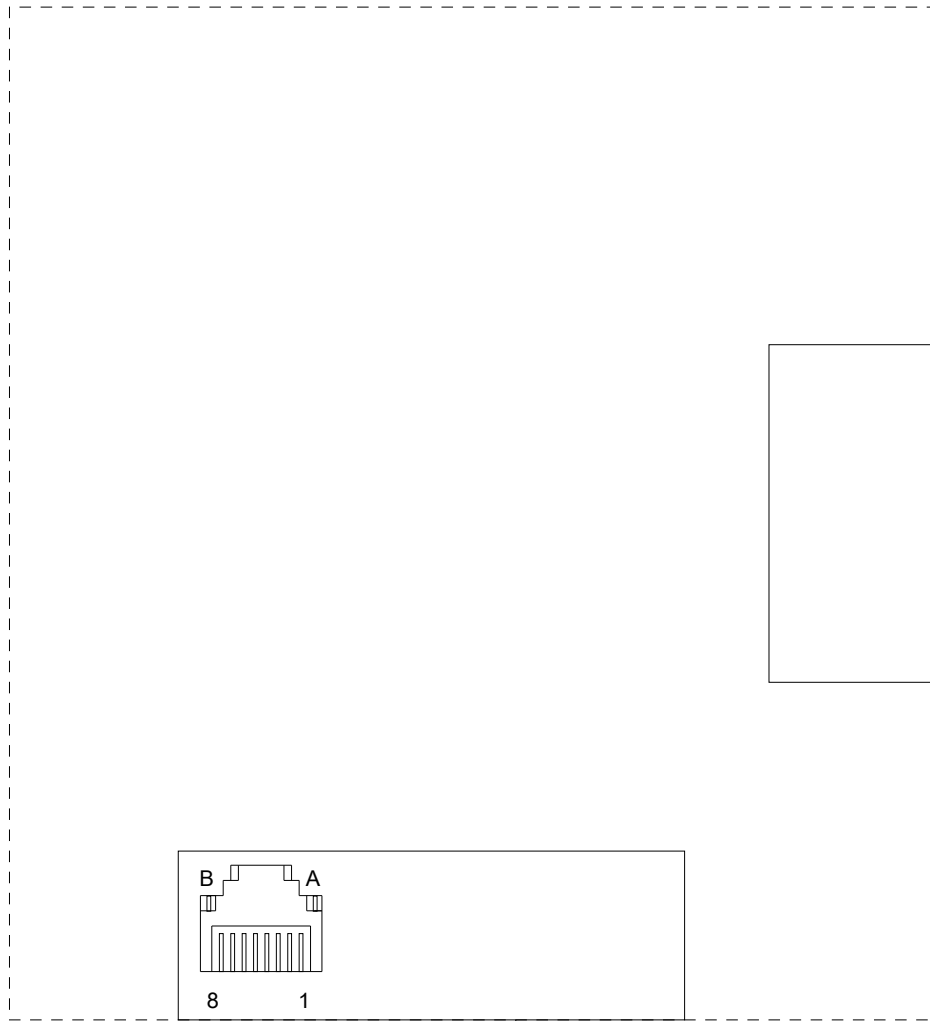

-X31

-X1:P1

last modified:

03/31/2020