

Circuit breaker VL400 UL; Type JG (CAT NO. HJS3S400) non-interchangeable frame, with approval circuit breaker according to UL 489 High switching capacity 3-pole, NEMA rating 65 kA/480 V, Overcurrent release magnetic TU=40 °C $I_n \leq 400$ A, Rated current $I_l=4400$ A Short-circuit protection non-automatic air circuit breaker without connection accessories

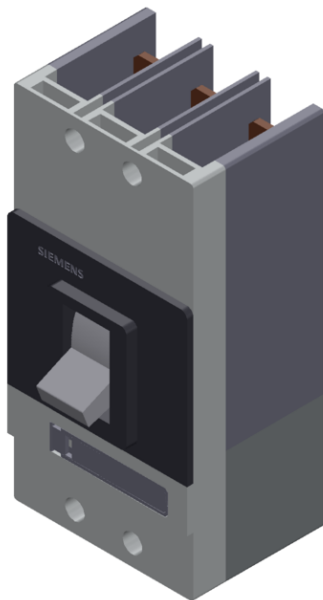

Model	
Type of the driving mechanism / motor drive	No
Design of the overcurrent release	M

General technical data	
Number of poles	3
Size of the circuit-breaker	3VL4 UL
Electrical endurance (switching cycles) / typical	10 000
Usage category	A
Performance class for circuit breaker	N
Mechanical service life (switching cycles) / typical	20 000
Reference identifier / acc. to DIN 40719 extended according to IEC 204-2 / acc. to IEC 750	Q
Operating frequency / maximum	120 1/s

Voltage	
Rated operational voltage U_e / max.	690 V
Insulation voltage	
• rated value	800 V
• at AC / rated value	800 V
Surge voltage resistance / rated value	8 kV

Protection class	
Protection class IP	IP20
Protective function of the overcurrent release	I

Dissipation	
Power loss [W]	
• maximum	90 W

Electricity	
Continuous current / rated value	400 A
Derating temperature / for the rated value of the continuous current	
• acc. to UL 489	40 °C
Adjustable pick-up value current	
• of instantaneous short-circuit trip unit / initial value	4 400 A
• of instantaneous short-circuit trip unit / Full-scale value	4 400 A

Main circuit	
Operating frequency	
• 1 / rated value	50 Hz
• 2 / rated value	60 Hz
Operating voltage	
• rated value / maximum	690 V

• for main current circuit / at AC / at 50 Hz / acc. to UL 489 / maximum	600 V
• for main current circuit / at AC / at 50 Hz / maximum	690 V
• for main current circuit / at AC / at 60 Hz / acc. to UL 489 / maximum	600 V
• for main current circuit / at AC / at 60 Hz / maximum	690 V
• for main current circuit / at DC / acc. to UL 489 / maximum	500 V

Suitability

Suitability for use	non-automatic circuit-breakers
----------------------------	--------------------------------

Product details

Product component

• Trip indicator	No
• Auxiliary switch	No
• Voltage trigger	No
• undervoltage release	No
• undervoltage release with leading contact	No

Product extension / optional / motor drive	Yes
--	-----

Product function

Product function

• of thermal overload trip unit	without
• Ground fault protection	No
• for neutral conductors / Short-circuit and overload proof	No
• Overload protection	No

Short circuit

Operational short-circuit current breaking capacity (Ics)

• at 240 V / rated value	75 kA
• at 415 V / rated value	70 kA
• at 690 V / rated value	8 kA

Maximum short-circuit current breaking capacity (Icu)

• at 240 V / rated value	100 kA
• at 415 V / rated value	70 kA
• at 480 V / acc. to NEMA / rated value	65 kA
• at 600 V / acc. to NEMA / rated value	25 kA
• at 690 V / rated value	15 kA

Connections

Arrangement of electrical connectors / for main current circuit	front side
Type of electrical connection / for main current circuit	without connection accessoires

Mechanical Design

Height	279.5 mm
Width	139.5 mm
Depth	163.5 mm
Mounting type	fixed mounting

Certificates

Certificate of suitability	UL high switching capacity (H), non-interchangeable
• Reference identifier / acc. to DIN EN 61346-2	Q

General Product Approval	EMC	Declaration of Conformity
---------------------------------	------------	----------------------------------



[Miscellaneous](#)



Test Certificates	Shipping Approval	other
--------------------------	--------------------------	--------------

[Special Test Certificate](#)



[Miscellaneous](#)

[Environmental Confirmations](#)

[Confirmation](#)

Further information

Information- and Downloadcenter (Catalogs, Brochures,...)

<http://www.siemens.com/lowvoltage/catalogs>

Industry Mall (Online ordering system)

<https://mall.industry.siemens.com/mall/en/en/Catalog/product?mlfb=3VL4140-2KE30-0AA0>

Service&Support (Manuals, Certificates, Characteristics, FAQs,...)

<https://support.industry.siemens.com/cs/ww/en/ps/3VL4140-2KE30-0AA0>

Image database (product images, 2D dimension drawings, 3D models, device circuit diagrams, ...)

http://www.automation.siemens.com/bilddb/cax_en.aspx?mlfb=3VL4140-2KE30-0AA0

CAX-Online-Generator

<http://www.siemens.com/cax>

Tender specifications

<http://www.siemens.com/specifications>