



RES.CURR. OP.CIRC. BR. SIQUENCE TYPE B SENS. TO. UNIV. CURRENT 63A 3+N-POL IFN 300MA 400V 4MW FOR SELECTIVE SWITCH OFF

Similar to image

#### Technical data:

Type, explanations		SIQUENCE RCCBs, type B selective
Type of mounting		DIN-Rail
Mounting depth	mm	70
Design of the fault-current type		B
Number of poles		4
Resistance against short-circuit current	kA	10
Number of pitch units for width		4
Size of installation devices / acc. to DIN 43880		1
Release fault-current / rated value	mA	300
Switching function / short-term delayed		No
Product feature / selective type		Yes
Supply voltage frequency / rated value	Hz	60
Resistance against the impulse current / rated value	kA	5
Breaking capacity current / rated value	kA	0.8
Breaking capacity current / acc. to EN 60898 / rated value	kA	0.8
Supply voltage / for AC / rated value	V	400
Current / for AC / rated value	A	63
circuit-breaker / Design		5SM3

I <sup>2</sup> t-value / permissible	A <sup>2</sup> ·s	70,000
Let-through current / permissible	kA	7,500
rated current I <sub>n</sub> / IEC, DIN/VDE / at 50 Cel	A	60.48
rated current I <sub>n</sub> / IEC, DIN/VDE / at 70 Cel	A	50.4
rated current I <sub>n</sub> / IEC, DIN/VDE / at 65 Cel	A	52.92
rated current I <sub>n</sub> / IEC, DIN/VDE / at 45 Cel	A	63
Break time / max. / permissible	s	0.4
rated current I <sub>n</sub> / IEC, DIN/VDE / at 40 Cel	A	63
rated current I <sub>n</sub> / IEC, DIN/VDE / at 55 Cel	A	57.96
rated current I <sub>n</sub> / IEC, DIN/VDE / at 60 Cel	A	55.44
Product extension / can be installed / supplementary device		Yes
Ambient conditions / degree of protection acc. to EN 60529		IP20
power loss	W	1.6
Short-circuit back-up fuse / maximum	A	100
Rated frequency f <sub>n</sub> / Hz		50 till 60Hz
CFC and silicone free		Yes
Rated currents I <sub>n</sub> / A		25, 40, 63, 80
Terminal tightening torques		2,5 till 3,0 Nm
Terminal conductor cross-sections, solid and stranded		1,5 till 25 mm <sup>2</sup>
Terminal conductor cross-sections, finely stranded with end sleeve		1.5 to 16mm <sup>2</sup>
Climatic resistance acc. to IEC 60068-2-30		28 cycles (55 °C; 95 % rel. humidity)

#### Further information:

##### Information- and Downloadcenter (Catalogs, Brochures,...)

<http://www.siemens.com/lowvoltage/catalogs>

##### Global Industry Mall (Online ordering system)

<http://www.siemens.com/lowvoltage/mall>

##### Service&Support (Manuals, Certificates, Characteristics, FAQs,...)

<http://support.automation.siemens.com/WWW/view/en/5SM3646-5/all>

##### Image database (product images, 2D dimension drawings, 3D models, device circuit diagrams, ...)

[http://www.automation.siemens.com/bilddb/cax\\_en.aspx?mlfb=5SM3646-5](http://www.automation.siemens.com/bilddb/cax_en.aspx?mlfb=5SM3646-5)

##### Tender specifications

[Datanorm GAEB81](#) [GAEB83](#) [RTF](#) [TXT](#)

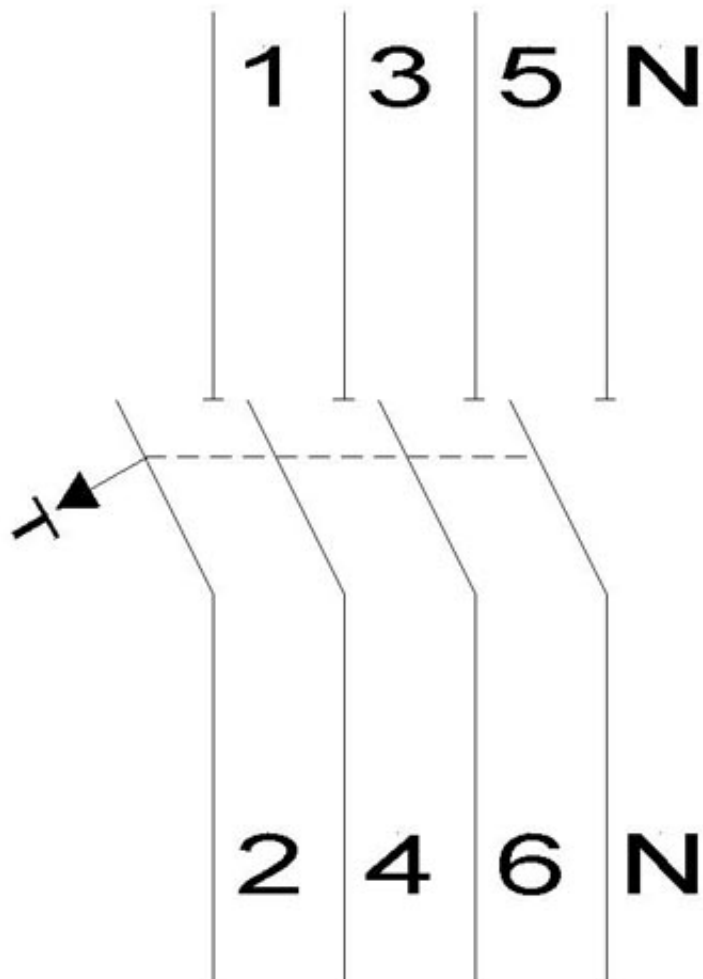
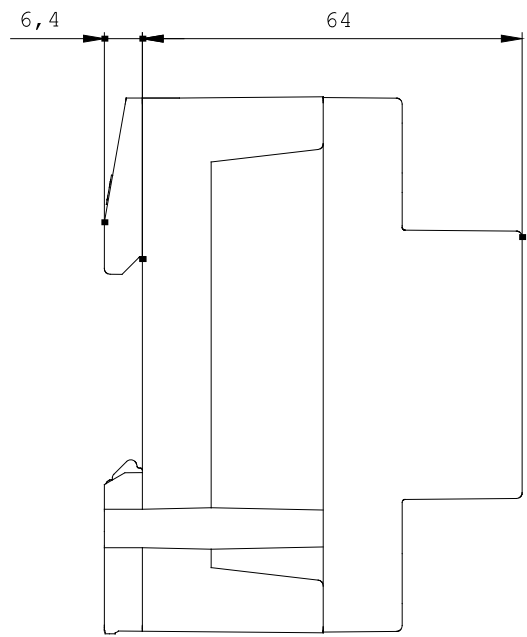
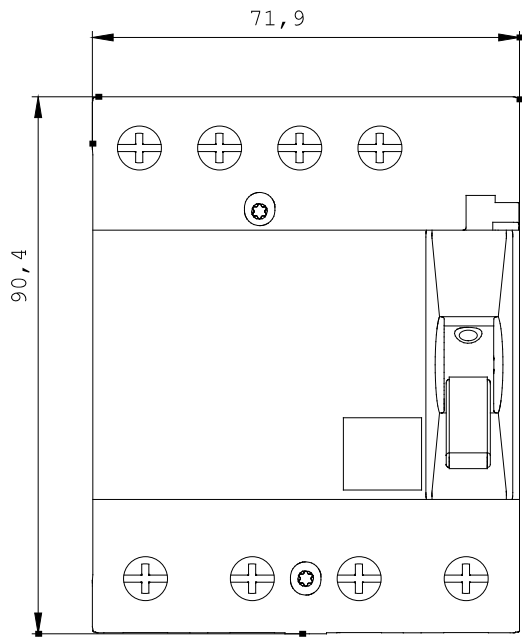

last change:

May 20, 2011