



RES.CURRENT OP.CIRCUIT BREAKER TYPE A PSE/SSF  
80A 3+N-POL IFN 300MA 400V 4MW

Similar to image

**Technical data:**

<b>Type, explanations</b>		RCCBs, type A, instantaneous
<b>Type of mounting</b>		DIN-Rail
<b>Mounting depth</b>	mm	70
<b>Design of the fault-current type</b>		A
<b>Number of poles</b>		4
<b>Resistance against short-circuit current</b>	kA	10
<b>Number of pitch units for width</b>		4
<b>Size of installation devices / acc. to DIN 43880</b>		1
<b>Release fault-current / rated value</b>	mA	300
<b>Switching function / short-term delayed</b>		No
<b>Product feature / selective type</b>		No
<b>Supply voltage frequency / rated value</b>	Hz	60
<b>Resistance against the impulse current / rated value</b>	kA	1
<b>Breaking capacity current / rated value</b>	kA	0.8
<b>Breaking capacity current / acc. to EN 60898 / rated value</b>	kA	0.8
<b>Supply voltage / for AC / rated value</b>	V	400
<b>Current / for AC / rated value</b>	A	80
<b>circuit-breaker / Design</b>		5SM3

I <sup>2</sup> t-value / permissible	A <sup>2</sup> ·s	70,000
Let-through current / permissible	kA	7,500
rated current I <sub>n</sub> / IEC, DIN/VDE / at 50 Cel	A	76.8
rated current I <sub>n</sub> / IEC, DIN/VDE / at 70 Cel	A	64
rated current I <sub>n</sub> / IEC, DIN/VDE / at 65 Cel	A	67.2
rated current I <sub>n</sub> / IEC, DIN/VDE / at 45 Cel	A	80
Break time / max. / permissible	s	0.1
rated current I <sub>n</sub> / IEC, DIN/VDE / at 40 Cel	A	80
rated current I <sub>n</sub> / IEC, DIN/VDE / at 55 Cel	A	73.6
rated current I <sub>n</sub> / IEC, DIN/VDE / at 60 Cel	A	70.4
Product extension / can be installed / supplementary device		Yes
Ambient conditions / degree of protection acc. to EN 60529		IP20, with connected conductors
power loss	W	1.2
Short-circuit back-up fuse / maximum	A	100
CFC and silicone free		Yes
Terminal tightening torques		2,5 till 3,0 Nm
Terminal conductor cross-sections, solid and stranded		1,5 till 25 mm <sup>2</sup>
Climatic resistance acc. to IEC 60068-2-30		28 cycles (55 °C; 95 % rel. humidity)

#### Further information:

##### Information- and Downloadcenter (Catalogs, Brochures,...)

<http://www.siemens.com/lowvoltage/catalogs>

##### Global Industry Mall (Online ordering system)

<http://www.siemens.com/lowvoltage/mall>

##### Service&Support (Manuals, Certificates, Characteristics, FAQs,...)

<http://support.automation.siemens.com/WW/view/en/5SM3647-6/all>

##### Image database (product images, 2D dimension drawings, 3D models, device circuit diagrams, ...)

[http://www.automation.siemens.com/bilddb/cax\\_en.aspx?mlfb=5SM3647-6](http://www.automation.siemens.com/bilddb/cax_en.aspx?mlfb=5SM3647-6)

##### Tender specifications

[Datanorm](#) [GAEB81](#) [GAEB83](#) [RTF](#) [TXT](#)

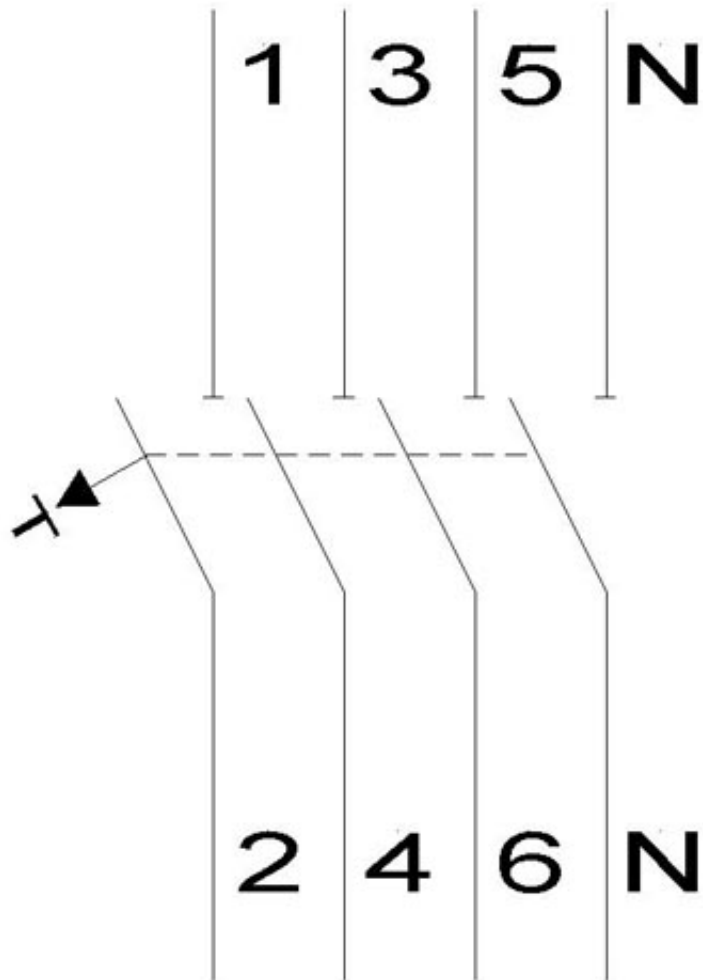
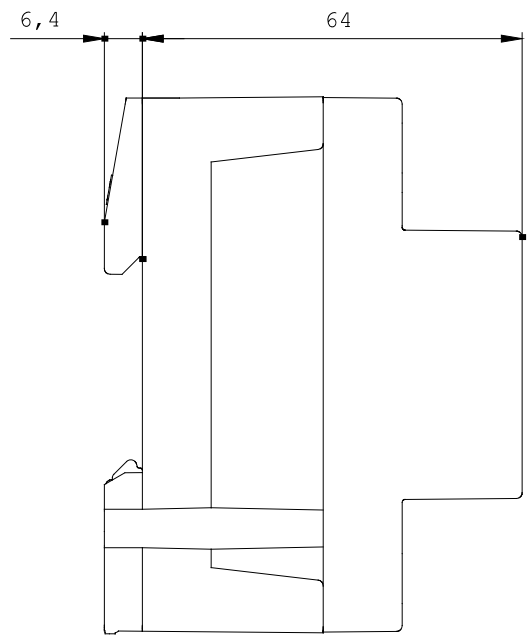
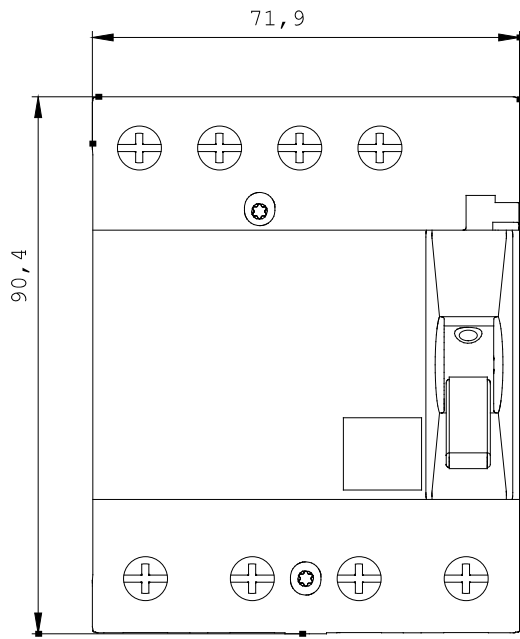

last change:

May 20, 2011