



Door-coupling rotary operating mechanism Emergency switching-off without tolerance compensation Size 75x 75, Shaft 8x 8, 300 mm, 0-I, Complete unit Handle size 45 mm Accessory for 3KD size 1 and 2, 3KF size 1

Model			
product brand name	SENTRON		
product designation	Door mounted rotary operator		
design of the product	EMERGENCY OFF without tolerance compensation		
design of handle	Red-yellow		
design of the door lock system	Door interlocking		
size of cross-section of the shaft of door-coupling rotary operating mechanism	8x8 mm		
size format of the masking frame of door-coupling rotary operating mechanism	75x 75 mm		
length of handle	45 mm		
length of shaft of door-coupling rotary operating mechanism	300 mm		
protection class IP	IP65		
suitability for use	3KC0 MTSE, 3KD size 1 and 2, 3KF size 1		
Product details			
product description	size 100x100 mm, shaft 8 x 8 mm		
product component			
• extension shaft	Yes		
• handle for emergency-OFF function	Yes		
product feature lockable	Yes		
display version for switch position indicator	0-I		
Mechanical Design			
height	105 mm		
width	88 mm		
depth	445 mm		
net weight	622 g		
General Product Approval	Declaration of Conformity	Marine / Shipping	other



[Miscellaneous](#)

[Confirmation](#)

Environment

[Environmental Confirmations](#)

Further information

Siemens has decided to exit the Russian market (see here).

<https://press.siemens.com/global/en/pressrelease/siemens-wind-down-russian-business>

Siemens is working on the renewal of the current EAC certificates.

Please contact your local Siemens office on the status of validity of the EAC certification if you intend to import or offer to supply these products to an EAC relevant market (other than the sanctioned EAEU member states Russia or Belarus).

Information on the packaging

<https://support.industry.siemens.com/cs/ww/en/view/109813875>

Information- and Downloadcenter (Catalogs, Brochures,...)

<http://www.siemens.com/lowvoltage/catalogs>

Industry Mall (Online ordering system)

<https://mall.industry.siemens.com/mall/en/en/Catalog/product?mlfb=8UD1171-2AD15>

Service&Support (Manuals, Certificates, Characteristics, FAQs,...)

<https://support.industry.siemens.com/cs/ww/en/ps/8UD1171-2AD15>

Image database (product images, 2D dimension drawings, 3D models, device circuit diagrams, ...)

http://www.automation.siemens.com/bilddb/cax_en.aspx?mlfb=8UD1171-2AD15

CAX-Online-Generator

<http://www.siemens.com/cax>

Tender specifications

<http://www.siemens.com/specifications>

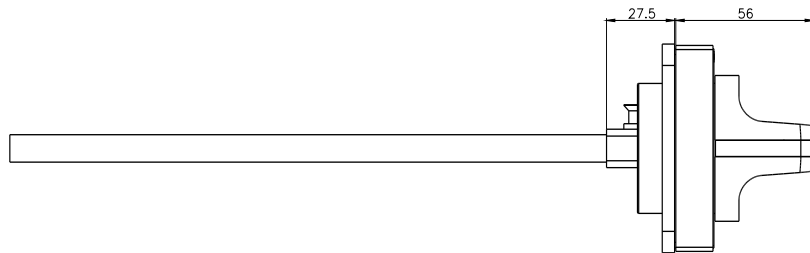
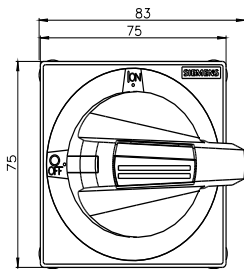

last modified:

7/29/2022 

