

SIGNALLING COLUMN SINGLE-FLASH LIGHT ELEMENT  
YELLOW, 24V DC



#### General technical data:

|  |                    |
|--|--------------------|
| product brandname                                    | SIRIUS             |
| Product designation                                  | Flashlight element |
| Design of the optical signal                         | flash light        |
| Type of voltage of the operating voltage             | DC                 |
| Operating voltage                                    |                    |
| • 1 at DC rated value                                | 24 V               |
| Relative positive tolerance of the operating voltage | 10 %               |
| Relative negative tolerance of the operating voltage | -10 %              |
| Equipment marking                                    |                    |
| • acc. to DIN EN 61346-2                             | P                  |
| • acc. to DIN EN 81346-2                             | P                  |

#### Mechanical data:

|   |       |
|---|-------|
| Outer diameter of the signal column element | 70 mm |
|---|-------|

#### Lamp:

|                                |                          |
|--------------------------------|--------------------------|
| Product component Light source | Yes                      |
| Type of light source           | Xenon gas discharge lamp |
| Flash frequency                | 1 Hz                     |

|                 |           |
|-----------------|-----------|
| Light intensity | 52 304 cd |
|-----------------|-----------|

#### Ambient conditions:

|                                      |                |
|--------------------------------------|----------------|
| Ambient temperature during operation | -20 ... +50 °C |
| Protection class IP                  | IP65           |
| Height                               | 65.5 mm        |
| Width                                | 70 mm          |

#### Certificates/approvals

| General Product Approval | EMC | Declaration of Conformity | other |
|--------------------------|-----|---------------------------|-------|
|--------------------------|-----|---------------------------|-------|



[Confirmation](#)

#### Further information

##### Information- and Downloadcenter (Catalogs, Brochures,...)

<http://www.siemens.com/industrial-controls/catalogs>

##### Industry Mall (Online ordering system)

<https://mall.industry.siemens.com/mall/en/en/Catalog/product?mlfb=8WD4420-0CD>

##### Cax online generator

<http://support.automation.siemens.com/WW/CAXorder/default.aspx?lang=en&mlfb=8WD4420-0CD>

##### Service&Support (Manuals, Certificates, Characteristics, FAQs,...)

<https://support.industry.siemens.com/cs/ww/en/ps/8WD4420-0CD>

##### Image database (product images, 2D dimension drawings, 3D models, device circuit diagrams, EPLAN macros, ...)

[http://www.automation.siemens.com/bilddb/cax\\_de.aspx?mlfb=8WD4420-0CD&lang=en](http://www.automation.siemens.com/bilddb/cax_de.aspx?mlfb=8WD4420-0CD&lang=en)

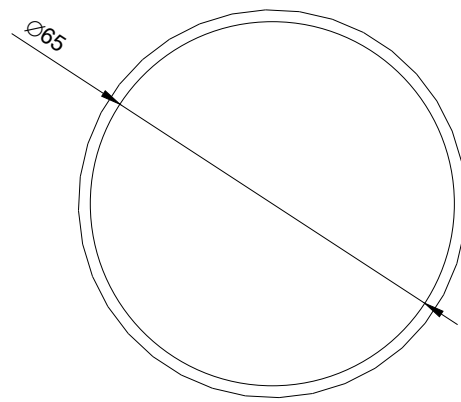
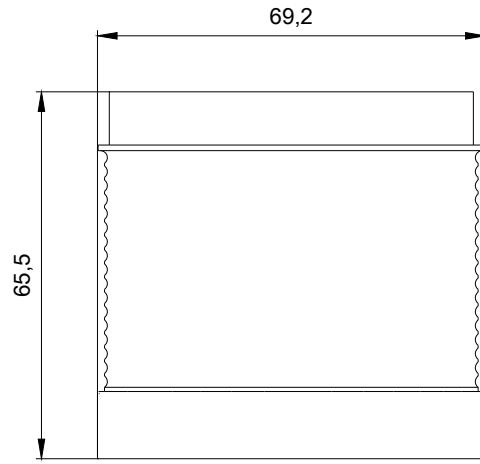

last modified:

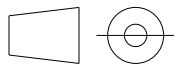

WS 4444;  
W6.8333; 8WD44...\_ALL  
07/26/2017