

THERMISTOR MOTOR PROTECTION COMPACT
EVALUATION UNIT AUTO, 1W, AC/DC 24V SCREW
CONNECTION



General technical data:

Type of voltage		AC/DC
Supply voltage frequency		
<ul style="list-style-type: none"> • 1 for auxiliary and control current circuit <ul style="list-style-type: none"> — rated value • 2 for auxiliary and control current circuit rated value 	Hz	50
	Hz	60
Control supply voltage		
<ul style="list-style-type: none"> • 1 <ul style="list-style-type: none"> — at AC <ul style="list-style-type: none"> — at 50 Hz rated value — at 60 Hz rated value — at DC <ul style="list-style-type: none"> — rated value 	V	24
	V	24
	V	24
Number of measuring circuits		1
Number of NC contacts for auxiliary contacts		0
Number of NO contacts for auxiliary contacts		0
Number of CO contacts for auxiliary contacts		1
Measurable temperature		

• initial value	°C	60
• Full-scale value	°C	180
Product function		
• reclosing lockout		No
• Auto-reset		Yes
• Fault storage		No
• External reset		No
Equipment marking acc. to DIN EN 61346-2		K
Equipment marking acc. to DIN 40719 extended according to IEC 204-2 acc. to IEC 750		K
Ambient temperature during operation	°C	-25 ... +60

Mechanical data:

Type of electrical connection for auxiliary and control current circuit		screw-type terminals
Type of electrical connection Plug-in socket		No
Display version LED		Yes
Protection class IP		IP20
Width	mm	22.5
Height	mm	83
Depth	mm	91

Certificates/ approvals:

General Product Approval	EMC	For use in hazardous locations
--------------------------	-----	--------------------------------



Declaration of Conformity	Test Certificates	Shipping Approval
---------------------------	-------------------	-------------------



[spezielle Prüfbescheinigungen](#)



Shipping Approval	other
-------------------	-------



[Umweltbestätigung](#)

[sonstig](#)

[Bestätigungen](#)

Further information

Information- and Downloadcenter (Catalogs, Brochures,...)

<http://www.siemens.com/industrial-controls/catalogs>

Industry Mall (Online ordering system)

<http://www.siemens.com/industrymall>

Cax online generator

<http://support.automation.siemens.com/WW/CAXorder/default.aspx?lang=en&mlfb=3RN10001AB00>

Service&Support (Manuals, Certificates, Characteristics, FAQs,...)

<https://support.industry.siemens.com/cs/ww/en/ps/3RN10001AB00>

Image database (product images, 2D dimension drawings, 3D models, device circuit diagrams, EPLAN macros, ...)

http://www.automation.siemens.com/bilddb/cax_de.aspx?mlfb=3RN10001AB00&lang=en

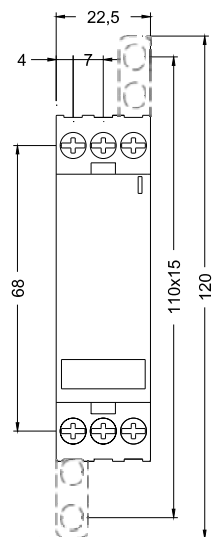

last modified:

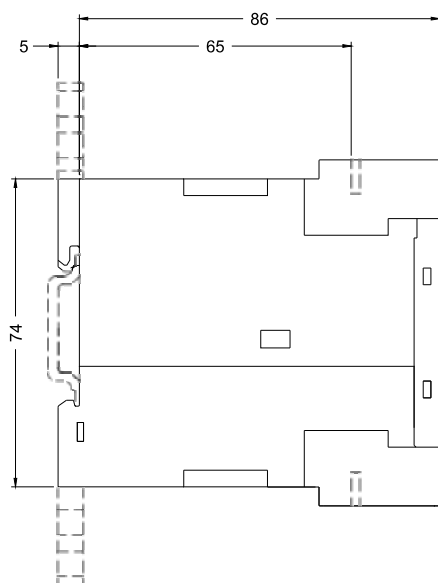

23.11.2015

