

**General Data :**

Construction regulation : 20 T 0964.0077  
Type : singel-phase cotrol transformer

Customer : Elektro Spangler  
identification : --

Constructional features : vertical magnetic axis  
Surface : resin impregnation  
According to regulation : DIN EN 60742, VDE 0551, DIN EN 61558, Teil 2-4 und 6, VDE 0570  
Conection : terminal block

Core section : EI 96 according to DIN 41302 T1  
Coil form : EI 96/45 1Ka/MS  
Material : V530-50  
Material : Durethan BKV30H

**Electrical data :**

Nominal input voltage V : 380-400-420  
Nominal output voltage V : 230  
Rated power kVA : 0,160  
Short time power kVA : --  
Frequency Hz : 50/60  
Temperature class : T40/E

Rated current A : 0,50-0,47-0,45  
Rated current A : 0,70  
Operation : DB  
Vector group : li0  
Percentage duty cycle : 100 %

**Testing :**

Type : Routine check test  
according to regulation : VDE 0570 2-4, High voltage test according to VDE 0551  
No-load test : Voltages and currents as nominal values (see above)  
High voltage test : 5 kV; chassis to winding and winding to winding for 60 sec.

**Terminal connecting diagramm :**

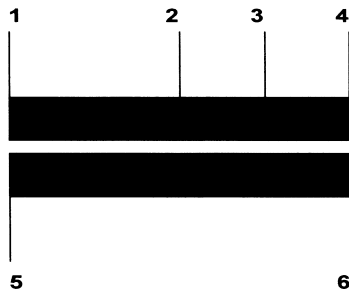

Primär

Sekundär

Terminal	1	2	3	4	5	6
Voltage	0	380	400	420	0	230

**Dimesions and weights :**

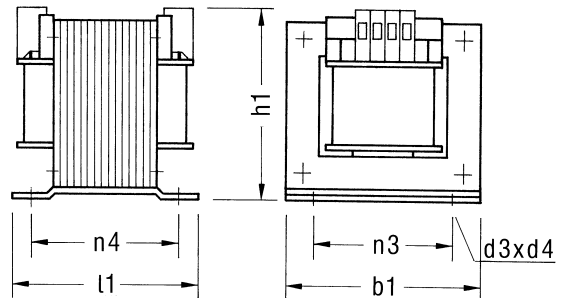

Dimensions in mm

l1	b1	h1	n3	n4	d3 x d4
88	96	106	84	73	5,8 x 9,0

Total weight : 3,00kg

**Special features :**

mounting size according to DIN 41 308

Date : 28. Juni 2006/JE

