

**W-series terminal with clamping yoke connection
WDU 10**

Weidmüller Interface GmbH & Co. KG
 Klingenbergstraße 16
 D-32758 Detmold
 Germany
 Fon: +49 5231 14-0
 Fax: +49 5231 14-2083
 www.weidmueller.com

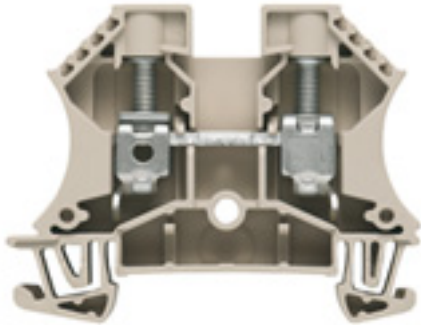

The versatile and extensive range of products - from 0.05 mm² to 300 mm² - means that you have diverse options for your applications at your disposal.

Hardened steel for mechanical strength and high-quality tinned copper for optimum conductivity. All materials comply with RoHS requirements and have been tested to current environment guidelines.

General ordering data

Order No.	1020300000
Part designation	WDU 10
Version	W-series terminal with clamping yoke connection, Feed-through terminal, Rated cross-section: 10 mm ² , Screw connection, Direct mounting
GTIN (EAN)	4008190068868
Qty.	50 pc(s).

**W-series terminal with clamping yoke connection
WDU 10**

Weidmüller Interface GmbH & Co. KG
Klingenbergstraße 16
D-32758 Detmold
Germany
Fon: +49 5231 14-0
Fax: +49 5231 14-2083
www.weidmueller.com

Technical data

Dimensions

Length	60 mm	Width	9.9 mm
Height	47 mm	Weight	18.46 g

Temperature

Ambient temperature (operational)	-50 °C...+120 °C	Storage temperature	
-----------------------------------	------------------	---------------------	--

CSA ratings data

Certificate no.	200039-1057876	Voltage size C	600 V
Current size C (CSA)	50 A	Conductor cross-section, max.	6 AWG
Conductor cross-section, min.	18 AWG		

UL ratings data

Certificate no.	E60693VOL1SEC38	Voltage size C	600 V
Current size C (UR)	65 A	Conductor size Factory wiring, max	6 AWG
Conductor size Factory wiring, min	18 AWG	Conductor size Field wiring, max	6 AWG

IECEX/ATEX rating data

Certificate no.	KEMA98ATEX1683U	ATEX certificate	KEMA98ATEX1683U_d.pdf
ATEX certificate	KEMA98ATEX1683U_e.pdf	Certificate no.	IECEXULD05.0008U
IEC Ex certificate	IECEXULD05.0008U_e.pdf	max. voltage	550 V
Current (ATEX)	50 A	Conductor cross-section, max.	10 mm ²
max. voltage	550 V	Current (IECEX)	50 A
Conductor cross-section, max.	10 mm ²	Voltage when using cross-connections	CrossConnectionGuide.pdf
Operating temperature range	For operating temperature range see EC Design Test Certificate / IEC Ex-Certificate of Conformity	Marking EN 60079-7	
			Ex e II

Material data

Material	Wemid	Colour	beige
Flammability class UL 94	V-0		

System specifications

Product family	W-series terminal with clamping yoke connection	Type of connection	Screw connection
Connection direction	on side	Number of levels	1
No. of connections	2	No. of clamping points per level	2
Levels cross-connected internally	No	Mounting rail	TS 35
End cover plate required	No		

2 clampable conductors (H05V/H07V) with equal cross-section (rated connection)

Conductor cross-section, solid, 2 clampable conductor	1 mm ²	Solid, max.	6 mm ²
Flexible, min.	1 mm ²	Flexible, max.	6 mm ²
Conductor cross-section, flexible plus plastic collar DIN 46228/1, 2 clampable conductor, min.	1 mm ²	Conductor cross-section, flexible plus plastic collar DIN 46228/1, 2 clampable conductor, max.	6 mm ²

**W-series terminal with clamping yoke connection
WDU 10**

Weidmüller Interface GmbH & Co. KG
Klingenbergstraße 16
D-32758 Detmold
Germany
Fon: +49 5231 14-0
Fax: +49 5231 14-2083
www.weidmueller.com

Technical data

Additional technical data

Explosion-tested version	Yes	Installation advice	Direct mounting
Number of identical terminals	1	Open sides	right
Type of mounting	Snap-on		

Conductors for clamping (additional connection)

Rated current	57 A	Type of connection	Screw connection
Clamping screw	M 4	Blade size	1.0 x 5.5 mm
Tightening torque, max.	2.4 Nm	Tightening torque, min.	1.5 Nm
Conductor connection cross-section AWG, min.	AWG 16	Conductor connection cross-section AWG, max.	AWG 6

Conductors for clamping (rated connection)

Type of connection	Screw connection	Stripping length	12 mm
Blade size	1.0 x 5.5 mm	Connection direction	on side
No. of connections	2	Clamping range, min.	1.31 mm ²
Clamping range, max.	16 mm ²	Clamping screw	M 4
Tightening torque, min.	1.5 Nm	Tightening torque, max.	2.4 Nm
Torque setting with DMS electric screwdriver 4		Gauge to IEC 60947-1	B6
Conductor cross-section, solid, min.	1.5 mm ²	Conductor cross-section, solid, max.	16 mm ²
Stranded, min.	1.5 mm ²	Stranded, max.	16 mm ²
Conductor cross-section, flexible, max.	16 mm ²	Conductor cross-section, flexible plus plastic collar DIN 46228/1, rated connection, min.	1.5 mm ²
Conductor cross-section, flexible plus plastic collar DIN 46228/1, rated connection, max.	16 mm ²	Conductor cross-section, flexible AEH plus plastic collar DIN 46228/4, rated connection, min.	1.5 mm ²
Conductor cross-section, flexible AEH plus plastic collar DIN 46228/4, rated connection, max.	16 mm ²	Twin wire-end ferrule, min.	1.5 mm ²
Twin wire-end ferrule, max.	6 mm ²	Conductor connection cross-section AWG, min.	AWG 16
Conductor connection cross-section AWG, max.	AWG 6		

Rating data

Rated cross-section	10 mm ²	Rated voltage	1,000 V
Rated impulse withstand voltage	8 kV	Rated current	57 A
Current with max. conductor	76 A	Standards	IEC 60947-7-1
Pollution severity	3		

Approvals

Approvals institutes	BURVER; CSA; CSAEX; CURUSEX; DETNORVER; GERMLLOYD; GOSTEX; GOSTME25; IECEXULD; KEMAATEX; KEMAKEUR; LLOYDSREG; MARITREG; NEMKO; RINA; UR; CE
----------------------	---

Classifications

ETIM 2.0	EC000897	ETIM 3.0	EC000897
UNSPSC	30-21-18-11	eClass 4.1	27-14-11-20
eClass 5.1	27-14-11-20	eClass 6.0	27-14-11-20

Creation date December 28, 2010 3:13:25 PM CET

**W-series terminal with clamping yoke connection
WDU 10**

Weidmüller Interface GmbH & Co. KG
Klingenbergstraße 16
D-32758 Detmold
Germany
Fon: +49 5231 14-0
Fax: +49 5231 14-2083
www.weidmueller.com

Technical data**Product notes**

Note, ordering data	For colours available see section W-series accessories "Specific functions"
Note, accessories	Socket and test plug refer to W-series Accessories section Only 400 V when using the shielding rail LS 2,8 1056400000.
Product description	<p>Identical profiles from 2.5 to 10 mm² with uniform end and partition plates. An unsurpassed combination of many advantages!</p> <p>Their small size compared to the respective rated cross-section makes the modular terminals with the compact design very popular.</p>

Downloads

DXF	09255_WDU_10_DXF.dxf
STEP	1020300000_09255_WDU_10_GN_WAP_GE_STP.stp
3D model	

Datasheet

**W-series terminal with clamping yoke connection
WDU 10**

Weidmüller Interface GmbH & Co. KG
Klingenbergstraße 16
D-32758 Detmold
Germany
Fon: +49 5231 14-0
Fax: +49 5231 14-2083
www.weidmueller.com

Drawings

