

# EATON

Powering Business Worldwide

10/10 IL03407014Z (AWA2100-2127, Pub51211)

Instruction Leaflet  
Montageanweisung  
Notice d'installation  
Instrucciones de montaje

Istruzioni per il montaggio  
安装说明  
Инструкция по монтажу

mm <sup>2</sup>	AWG	Nm	lb-in
1 x (0.75 - 16)	14 - 8	3.2	28
2 x (0.75 - 10)			
1 x (0.75 - 16)			
2 x (0.75 - 10)			
1 x 16			

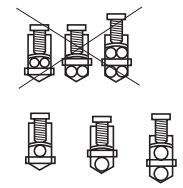

A1/A2 13/14 21/22	mm <sup>2</sup>	AWG	Nm	lb-in
	0.75 - 2.5	18 - 14	1.2	10.6

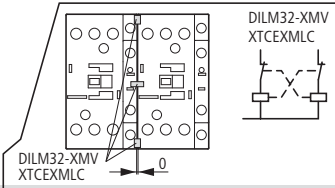

**DILM(C)17...M(C)38...  
DILMF8...MF32...  
XTCE...C, 18-38A**

**DILM(C)32-XHI1...  
DILM32-XHI11-S  
XTCEXFCC...**

**XTCEXSCC11**  
Auxiliary contact module  
Hilfsschalterbaustein  
Module de contacts auxiliaires  
Módulo de contactos auxiliares  
Modulo contatti ausiliari  
辅助开关组  
выключателей Модуль  
вспомогательных

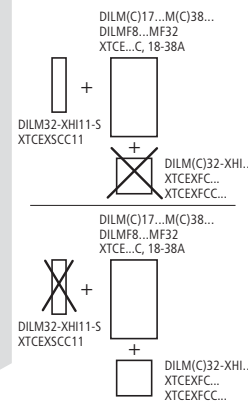

- |                   |                       |                     |                   |      |
|-------------------|-----------------------|---------------------|-------------------|------|
| <b>Mounting</b>   | 1 place in position   | 1 aufsetzen         | 1 mettre en place | 1 装配 |
| <b>Montage</b>    | 2 latch in            | 2 rasten            | 2 encliqueter     | 2 装上 |
| <b>Montage</b>    | 1 colocar en posición | 1 appoggiare        | 1 осадить         | 1 嵌入 |
| <b>Montaggio</b>  | 2 enclavar            | 2 inserire a scatto | 2 зафиксировать   |      |
| <b>安装</b>         |                       |                     |                   |      |
| <b>Демонтаж</b>   | 3 push                | 3 schieben          | 3 pousser         | 3 推  |
| <b>Demontage</b>  | 4 remove              | 4 abziehen          | 4 retirer         | 4 拔出 |
| <b>Démontage</b>  | 3 deslazar            | 3 inserir           | 3 задвинуть       |      |
| <b>Smontaggio</b> | 4 extraer             | 4 estrarre          | 4 снять           |      |
| <b>Desmontaje</b> |                       |                     |                   |      |
| <b>拆卸</b>         |                       |                     |                   |      |
| <b>Разборка</b>   |                       |                     |                   |      |

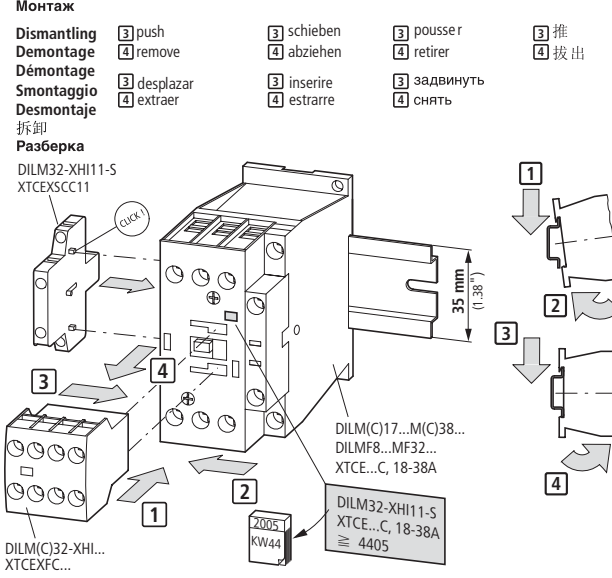

Mounting position – Einbaulage  
Position de montage – Posición de montaje  
Posizione di montaggio – 安装位置  
Положение установки

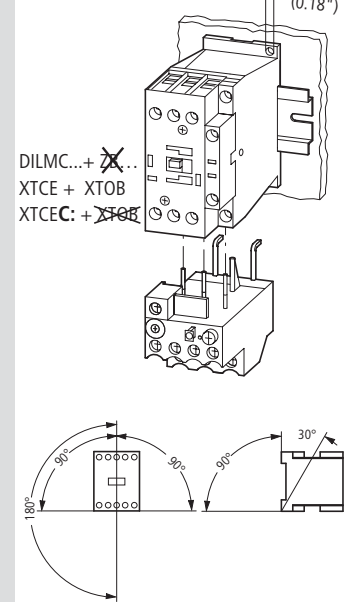

**DILM(C)17...M(C)38...  
DILMF8...MF32...  
18, 25 and 32A  
XTCE... and XTCEC...**

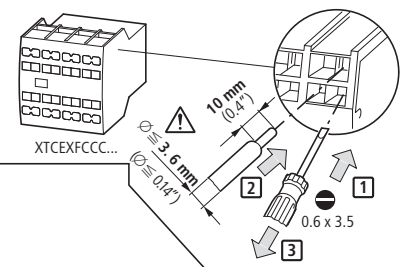
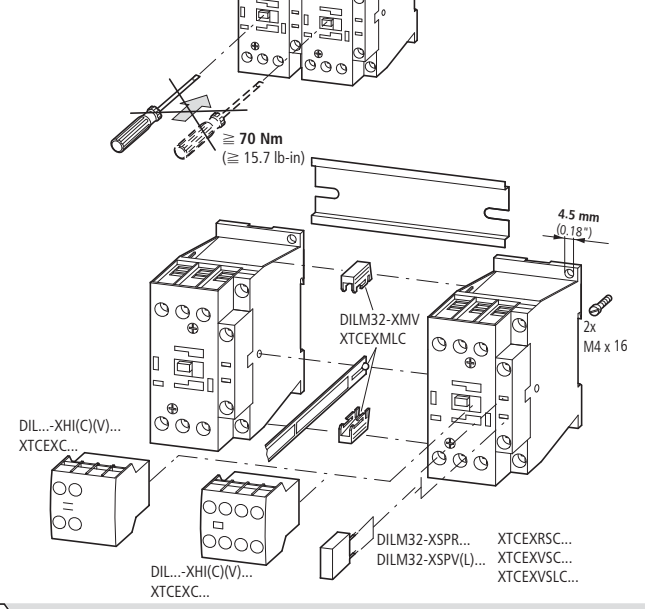

**Danger!**  
The opening of the branch-circuit protective device may be an indication that a fault has been interrupted. To reduce the risk of fire or electrical shock, current-carrying parts and other components of the controller should be examined and replaced if damaged. If burnout of the element of an overload relay occurs, the complete overload relay must be replaced.

**DIULM...  
SDAINLM...  
XTCR...**