

SIEMENS

Drehantrieb
Rotary Operating Mechanism
Commande rotative
Accionamiento giratorio
Comando rotativo
Acionamento rotativo
Döner tahrik mekanizması
Поворотный привод
门控旋转传动装置

3VL9400-3HA0.
3VL9400-3HC0.
3VL9400-3A.10

SENTRON® VL



Betriebsanleitung Operating Instructions Instructions de service Instructivo Istruzioni operative
Instruções de Serviço İşletme kılavuzu Инструкция по эксплуатации 使用说明

	Deutsch	English	Français
	Vor der Installation, dem Betrieb oder der Wartung des Geräts muss diese Anleitung gelesen und verstanden werden.	Read and understand these instructions before installing, operating, or maintaining the equipment.	Ne pas installer, utiliser ou intervenir sur cet équipement avant d'avoir lu et assimilé les présentes instructions et notamment les conseils de sécurité et mises en garde qui y figurent.
	⚠ GEFÄHR	⚠ DANGER	⚠ DANGER
	Gefährliche Spannung. Lebensgefahr oder schwere Verletzungsgefahr. Vor Beginn der Arbeiten Anlage und Gerät spannungsfrei schalten.	Hazardous voltage. Will cause death or serious injury. Turn off and lock out all power supplying this device before working on this device.	Tension électrique. Danger de mort ou risque de blessures graves. Mettez hors tension avant d'intervenir sur l'appareil.
	VORSICHT	CAUTION	PRUDENCE
	Eine sichere Gerätefunktion ist nur mit zertifizierten Komponenten gewährleistet!	Reliable functioning of the equipment is only ensured with certified components.	La sécurité de fonctionnement de l'appareil n'est garantie qu'avec des composants certifiés.
	Español	Italiano	Português
	Leer y comprender este instructivo antes de la instalación, operación o mantenimiento del equipo.	Leggere con attenzione queste istruzioni prima di installare, utilizzare o eseguire manutenzione su questa apparecchiatura.	Ler e compreender estas instruções antes da instalação, operação ou manutenção do equipamento.
	⚠ PELIGRO	⚠ PERICOLO	⚠ PERIGO
	Tensión peligrosa. Puede causar la muerte o lesiones graves. Desconectar la alimentación eléctrica antes de trabajar en el equipo.	Tensione pericolosa. Può provocare morte o lesioni gravi. Scollegare l'alimentazione prima di eseguire interventi sull'apparechiatura.	Tensão perigosa. Perigo de morte ou ferimentos graves. Desligue a corrente antes de trabalhar no equipamento.
	PRECAUCIÓN	CAUTELA	CUIDADO
	El funcionamiento seguro del aparato sólo está garantizado con componentes certificados.	Il funzionamento sicuro dell'apparechiatura è garantito soltanto con componenti certificati.	O funcionamento seguro do aparelho apenas pode ser garantido se forem utilizados os componentes certificados.
	Türkçe	Русский	中文
	Cihazın kurulumundan, çalıştırılmasından veya bakıma tabi tutulmasından önce, bu kılavuz okunmuş ve anlaşılmış olmalıdır.	Перед установкой, вводом в эксплуатацию или обслуживанием устройства необходимо прочесть и понять данное руководство.	安装、使用和维修本设备前必须先阅读并理解本说明。
	⚠ TEHLİKE	⚠ ОПАСНО	⚠ 危险
	Tehlikeli gerilim. Ölüm tehlikesi veya ağır yaralanma tehlikesi mevcuttur. Çalışmalara başlamadan önce, sistemin ve cihazın enerjisini kesiniz.	Опасное напряжение. Опасность для жизни или возможность тяжелых травм. Перед началом работ отключить подачу питания к установке и к устройству.	危险电压。可能导致生命危险或重伤危险。 操作设备时必须确保切断电源。
	ÖNEMLİ DİKKAT	ОСТОРОЖНО	警告
	Cihazın güvenli çalışması ancak sertifikalı bileşenler kullanılması halinde garanti edilebilir.	Безопасность работы устройства гарантировано только при использовании сертифицированных компонентов.	只有使用经过认证的部件才能保证设备的正常运转！

Technical Assistance: E-mail: technical-assistance@siemens.com
Internet: www.siemens.de/lowvoltage/technical-assistance

DE	Notwendige Werkzeuge für Montage
EN	Necessary assembly tools
FR	Outils nécessaires pour le montage
ES	Herramientas requeridas para el montaje
IT	Utensili necessari per il montaggio
PT	Ferramentas necessárias para a montagem
TR	Montaj için gerekli aletler
PY	Инструменты, необходимые для монтажа
中文	安装所需工具

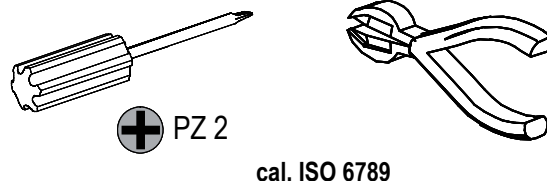

DE	Lieferumfang
EN	Quantity of delivery
FR	Composition de la fourniture
ES	Alcance del suministro
IT	Configurazione di fornitura
PT	Âmbito do fornecimento
TR	Teslimat hacmi
PY	Комплект поставки
中文	供货范围

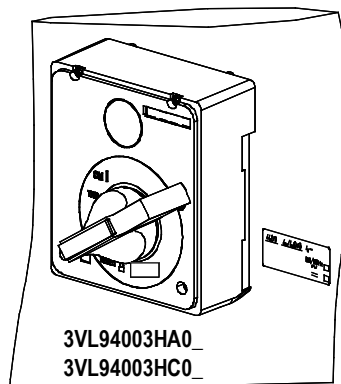

3VL9400-3AU10
EBS - "ON => OFF"

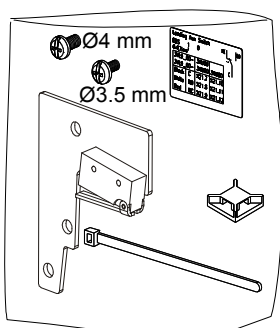

3VL9400-3AW10
EBS - "ON => OFF"

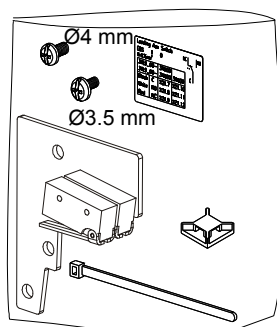

3VL9400-3AT10
EMS - "OFF => ON"

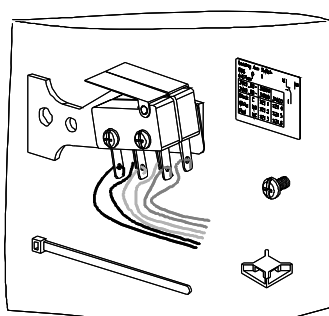

3VL9400-3AS10
EMS - "OFF => ON"

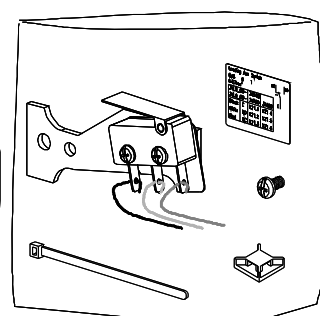

DE	Voreilender Öffnerkontakt
EN	Leading NC contact (Early - Break - auxiliary Switch, EBS)
FR	Contact NC à action anticipée
ES	Contacto NC anticipado
IT	Contatto NC anticipato
PT	Contato NF antecipado
TR	Kılavuz açıcı
PY	опережающий размыкающий контакт
中文	前置的常闭触头

DE	Voreilender Schließerkontakt
EN	Leading NO contact (Early - Make - auxiliary Switch, EMS)
FR	Contact NO à action anticipée
ES	Contacto NA anticipado
IT	Contatto NA anticipato
PT	Contato NA antecipado
TR	Kılavuz kapayıcı
PY	опережающий замыкающий контакт
中文	提前闭合常开触头（提前分闸）

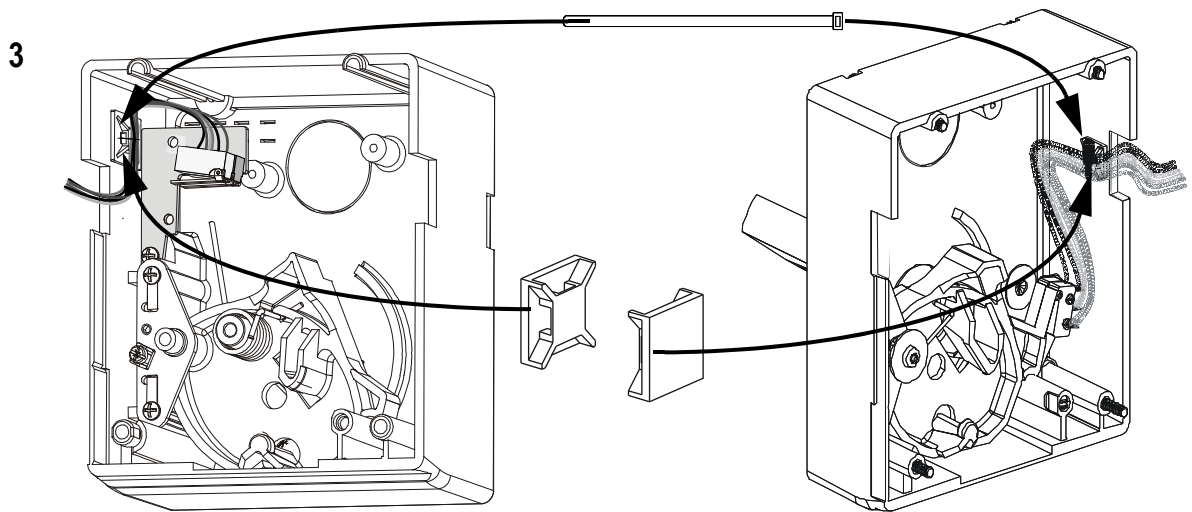
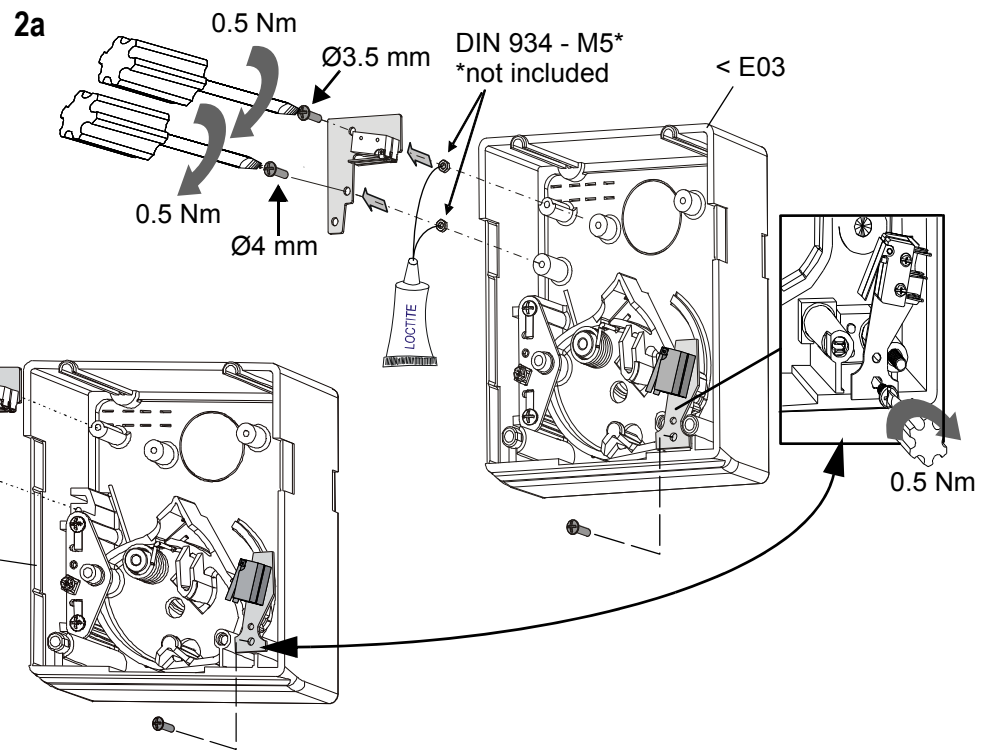
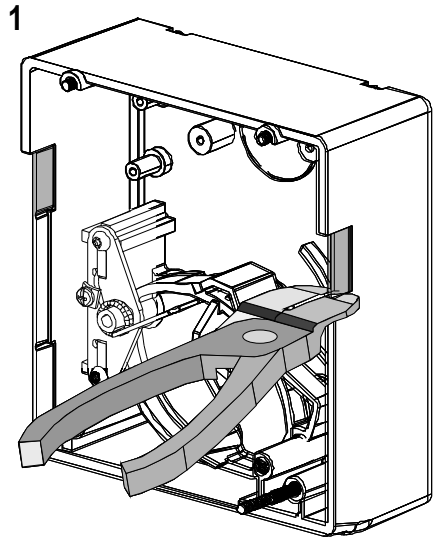

4

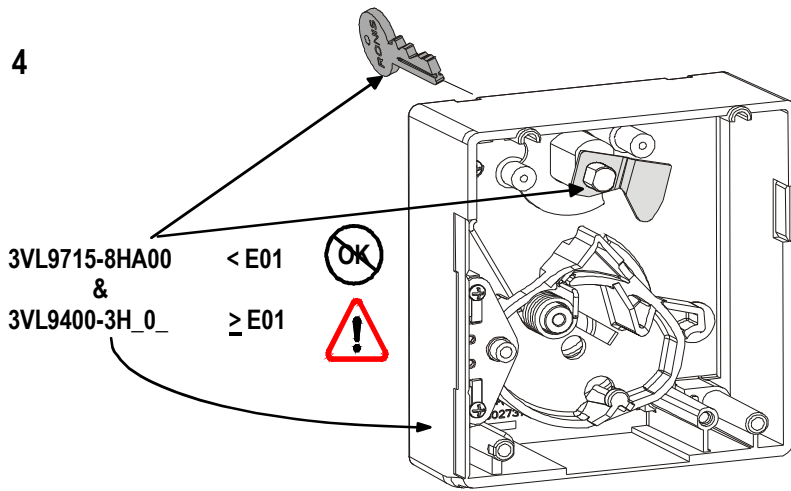

5

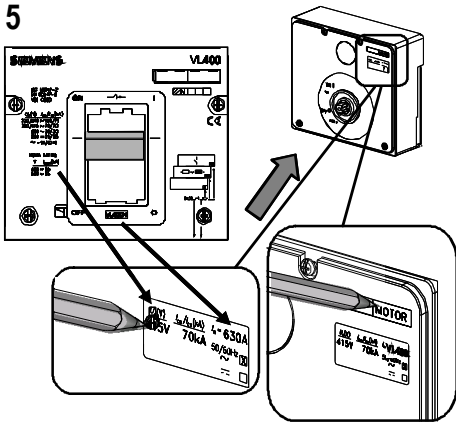

6

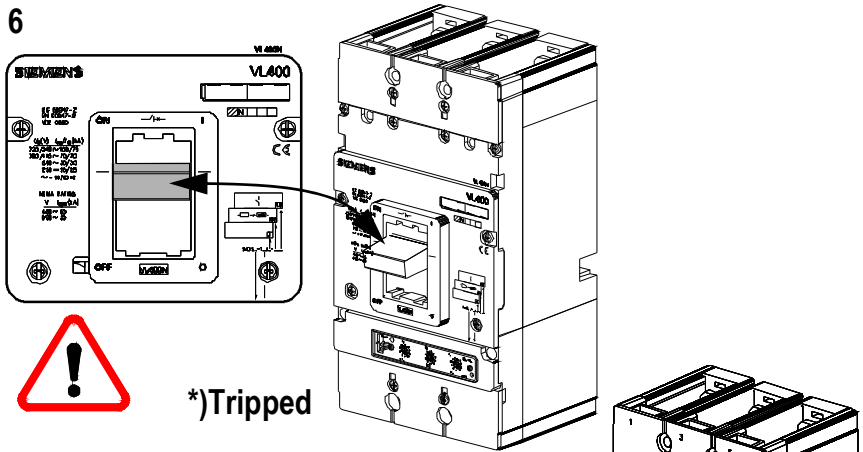

7

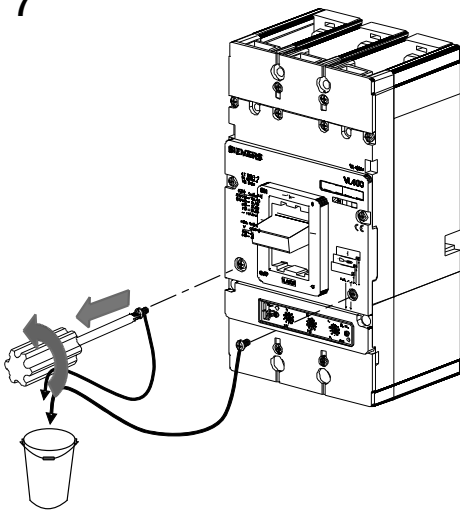

*)

DE	Ausgelöst
EN	Tripped
FR	Déclenché
ES	Disparado
IT	Sganciato
PT	Disparado
TR	Çözülme durumu
PY	Разомкнуто
中文	断开

8

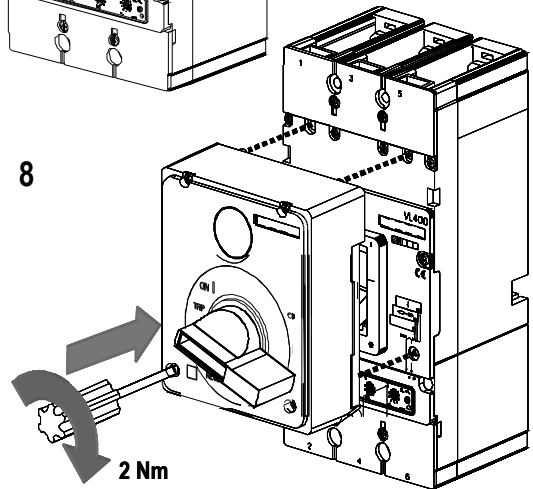

9

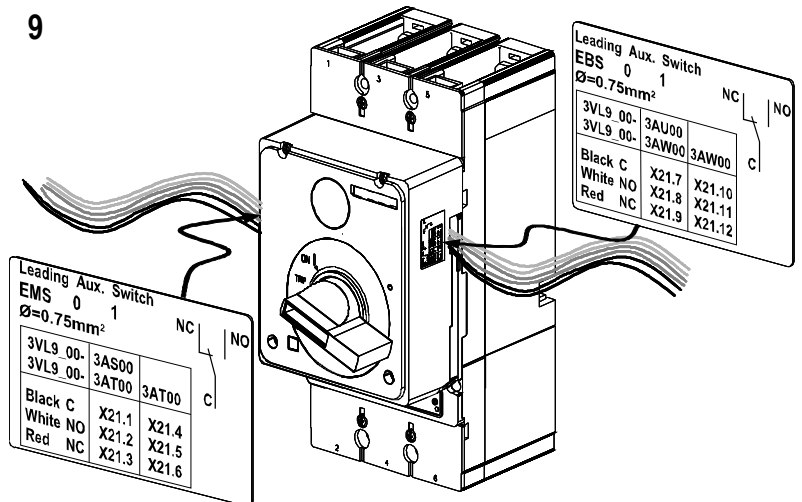

*) DE	Auslösen	EN	Trip	FR	Déclencher
ES	Disparar	IT	Sganciare	PT	Disparar
TR	Çözme	РУ	Размыкание	中文	脱扣

*)TRIP - TEST

10

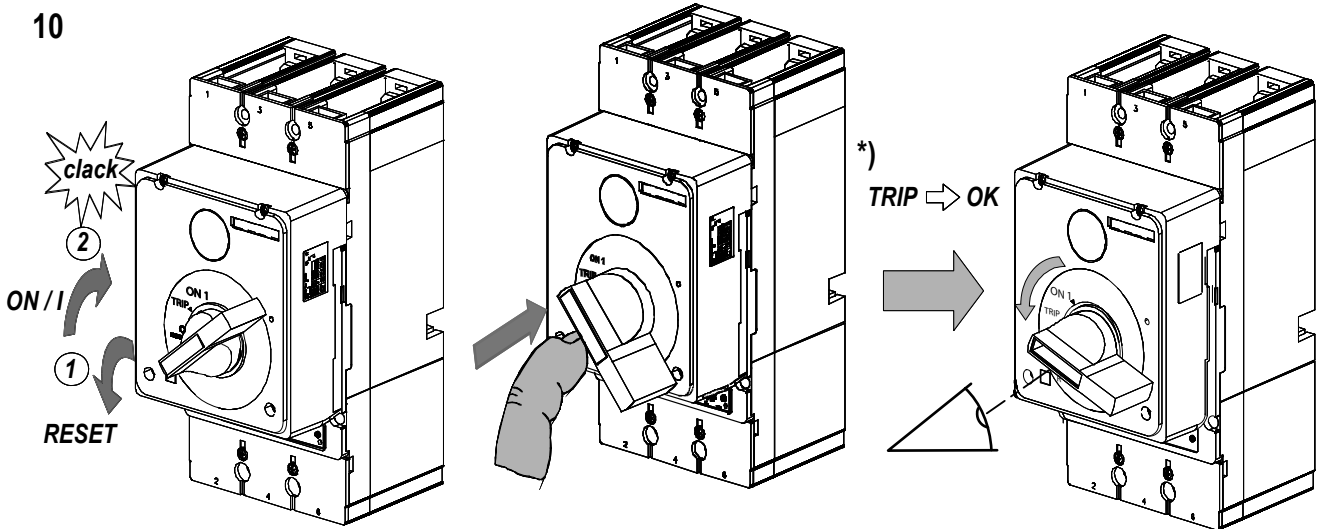

11

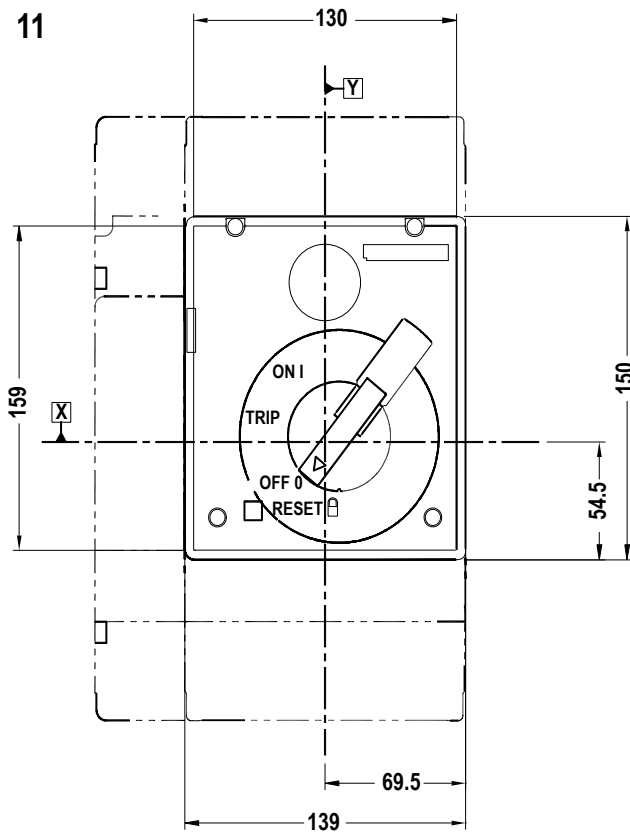

12

OPTION :
1 ... 3 / Ø 8 mm

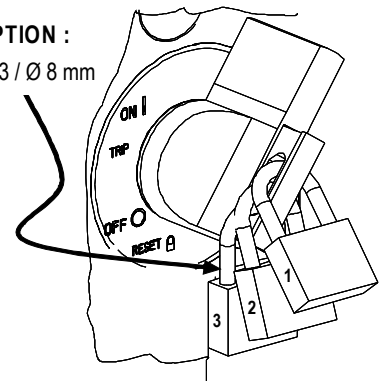

Deutsch	Option
English	Option
Français	Option
Español	Opcción
Italiano	Opzione
Português	Opção
Türkçe	Opşiyon
Русский	Опция
中文	选项

	C	NO	NC
DE	schwarz	weiß	rot
EN	black	white	red
FR	noir	blanc	rouge
ES	negro	blanco	rojo
IT	nero	bianco	rosso
PT	preto	branco	vermelho
TR	siyah	beyaz	kırmızı
PY	черный	белый	красный
中文	黑色	白色	红色
-3AS10	X21.1	X21.2	X21.3
-3AT10	X21.1 X21.4	X21.2 X21.5	X21.3 X21.6
-3AU10	x21.7	x21.8	x21.9
3AW10	X21.7 X21.10	X21.8 X21.11	X21.9 X21.12

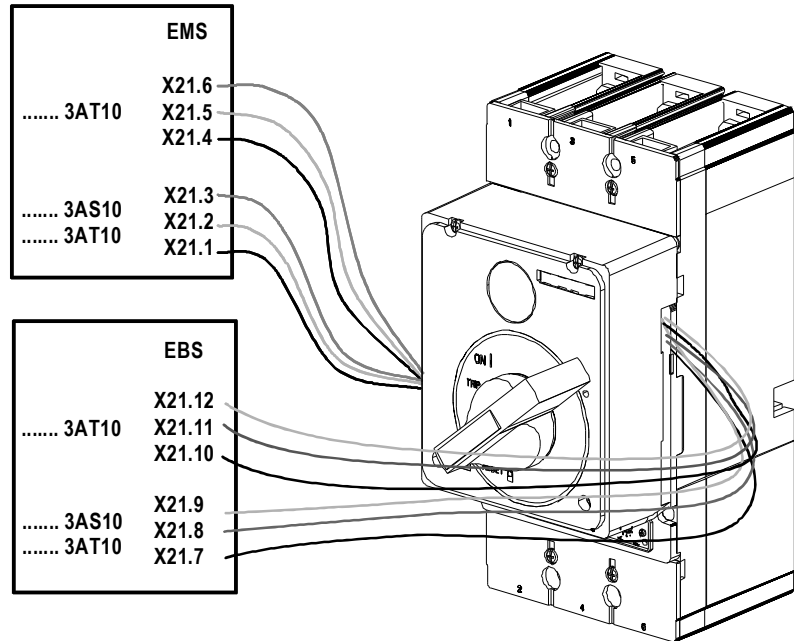

DE	Weitere Informationen finden Sie im 3VL-Handbuch im Internet unter: www.siemens.com/lowvoltage/manuals (nur in Deutsch und Englisch)
EN	Further information can be found in the 3VL manual on the internet at www.siemens.com/lowvoltage/manuals (only in German and English)
FR	Vous trouverez des informations supplémentaires dans le manuel 3VL sur le site Internet www.siemens.com/lowvoltage/manuals (seulement en allemand et en anglais)
ES	Para más información, consulte el manual 3VL que está disponible en nuestra página web www.siemens.com/lowvoltage/manuals (sólo en alemán e inglés)
IT	Ulteriori informazioni sono disponibili in Internet nel manuale 3VL su www.siemens.com/lowvoltage/manuals (solo in tedesco e in inglese)
PT	Mais informações encontram-se no manual 3VL na Internet, sob www.siemens.com/lowvoltage/manuals (somente em alemão e em inglês)
TR	Ayrıntılı bilgiyi aşağıdaki internet adresindeki 3VL kullanma kılavuzundan edinebilirsiniz: www.siemens.com/lowvoltage/manuals (sadece Almanca ve İngilizce olarak)
PY	Дальнейшую информацию Вы сможете найти в инструкции по эксплуатации 3VL в интернете по адресу: www.siemens.com/lowvoltage/manuals (только на немецком и английском языке)
中文	其他相关信息参见 3VL 使用手册，请登陆互联网： www.siemens.com/lowvoltage/manuals （德、英文）