

SIEMENS

Rahmenklemme für Cu / Anschlussklemme für Rundleiter Cu/Al

Wrap-Around Terminals for Cu, Terminal for Cu/Al

Boîte à bornes pour raccordement de câble, Cu, Al ou avec embout

Bornes de conexión tipo marco para cobre, cobre/Al

Morsetti per Cu, Cu/Al

Borne de estrutura para Cu / Borne de conexão para borne circular Cu/Al

Cu için çerçeve kısaç / Dairesel iletken Cu/Al için bağlantı kısaç

Рамочная клемма для CU /соединительная клемма для круглового провода Cu/Al

框形端子 铜 / 圆导线端子 铜 / 铝

3VL9100-4TC.0

3VL9100-4TD.0

3VL9200-4TC.0

3VL9200-4TD.0

3VL9300-4TC.0

3VL9300-4TD.0

for Sentron

VL160X - VL250

SENTRON® VL



Betriebsanleitung Instruções de Serviço	Operating Instructions İşletme kılavuzu	Instructions de service Инструкция по эксплуатации	Instruivo 使用说明	Istruzioni operative
Deutsch	English	Français		
Vor der Installation, dem Betrieb oder der Wartung des Geräts muss diese Anleitung gelesen und verstanden werden.	Read and understand these instructions before installing, operating, or maintaining the equipment.	Ne pas installer, utiliser ou intervenir sur cet équipement avant d'avoir lu et assimilé les présentes instructions et notamment les conseils de sécurité et mises en garde qui y figurent.		
⚠ GEFÄHR	⚠ DANGER	⚠ DANGER		
Gefährliche Spannung. Lebensgefahr oder schwere Verletzungsgefahr. Vor Beginn der Arbeiten Anlage und Gerät spannungsfrei schalten.	Hazardous voltage. Will cause death or serious injury. Turn off and lock out all power supplying this device before working on this device.	Tension électrique Danger de mort ou risque de blessures graves. Mettre hors tension avant d'intervenir sur l'appareil.		
VORSICHT	CAUTION	PRUDENCE		
Eine sichere Gerätefunktion ist nur mit zertifizierten Komponenten gewährleistet!	Reliable functioning of the equipment is only ensured with certified components.	La sécurité de fonctionnement de l'appareil n'est garantie qu'avec des composants certifiés.		
Español	Italiano	Português		
Leer y comprender este instructivo antes de la instalación, operación o mantenimiento del equipo.	Leggere con attenzione queste istruzioni prima di installare, utilizzare o eseguire manutenzione su questa apparecchiatura.	Ler e compreender estas instruções antes da instalação, operação ou manutenção do equipamento.		
⚠ PELIGRO	⚠ PERICOLO	⚠ PERIGO		
Tensión peligrosa. Puede causar la muerte o lesiones graves. Desconectar la alimentación eléctrica antes de trabajar en el equipo.	Tensione pericolosa. Può provocare morte o lesioni gravi. Scollegare l'alimentazione prima di eseguire interventi sull'apparecchiatura.	Tensão perigosa. Perigo de morte ou ferimentos graves. Desligue a corrente antes de trabalhar no equipamento.		
PRECAUCIÓN	CAUTELA	CUIDADO		
El funcionamiento seguro del aparato sólo está garantizado con componentes certificados.	Il funzionamento sicuro dell'apparecchiatura è garantito soltanto con componenti certificati.	O funcionamento seguro do aparelho apenas pode ser garantido se forem utilizados os componentes certificados.		
Türkçe	Русский	中文		
Cihazın kurulumundan, çalıştırılmasından veya bakıma tabi tutulmasından önce, bu kılavuz okunmuş ve anlaşılmış olmalıdır.	Перед установкой, вводом в эксплуатацию или обслуживанием устройства необходимо прочесть и понять данное руководство.	安装、使用和维修本设备前必须先阅读并理解本说明。		
⚠ TEHLİKE	⚠ ОПАСНО	⚠ 危险		
Tehlikeli gerilim. Ölüm tehlikesi veya ağır yaralanma tehlikesi mevcuttur. Çalışmalara başlamadan önce, sistemin ve cihazın enerjisini kesiniz.	Опасное напряжение. Опасность для жизни или возможность тяжелых травм. Перед началом работ отключить подачу питания к установке и к устройству.	危险电压。可能导致生命危险或重伤危险。 操作设备时必须确保切断电源。		
ÖNEMLİ DİKKAT	ОСТОРОЖНО	警告		
Cihazın güvenli çalışması ancak sertifikalı bileşenler kullanılması halinde garanti edilebilir.	Безопасность работы устройства гарантировано только при использовании сертифицированных компонентов.	只有使用经过认证的部件才能保证设备的正常运转！		
Technical Assistance:	Telephone: +49 (0) 911-895-5900 (8° - 17° CET) E-mail: technical-assistance@siemens.com Internet: www.siemens.de/lowvoltage/technical-assistance	Fax: +49 (0) 911-895-5907		
Technical Support:	Telephone: +49 (0) 180 50 50 222			

DE	Notwendige Werkzeuge für Montage
EN	Necessary assembly tools
FR	Outils nécessaires pour le montage
ES	Herramientas requeridas para el montaje
IT	Utensili necessari per il montaggio
PT	Ferramentas necessárias para a montagem
TR	Montaj için gerekli aletler
PY	Инструменты, необходимые для монтажа
中文	安装所需工具

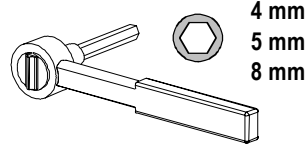

cal. ISO 6789

DE	Lieferumfang	EN	Quantity of delivery	FR	Composition de la fourniture
ES	Alcance del suministro	IT	Configurazione di fornitura	PT	Âmbito do fornecimento
TR	Teslimat hacmi	PY	Комплект поставки	中文	供货范围

VL160X (Cu / Al)
3VL9100-4TD30 = 3 x
3VL9100-4TD40 = 4 x

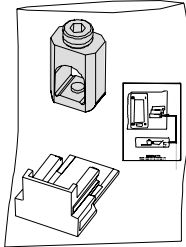

VL160X (Cu)
3VL9100-4TC30 = 3 x
3VL9100-4TC40 = 4 x

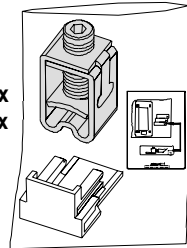

VL160 (Cu)
3VL9200-4TC30 = 3 x
3VL9200-4TC40 = 4 x

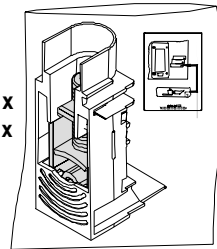

VL160 (Cu / Al)
3VL9200-4TD30 = 3 x
3VL9200-4TD40 = 4 x

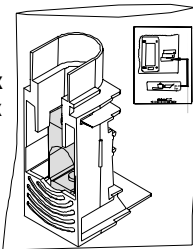

VL250 (Cu)
3VL9300-4TC30 = 3 x
3VL9300-4TC40 = 4 x

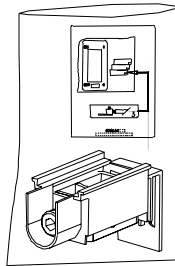

VL250 (Cu / Al)
3VL9300-4TD30 = 3 x
3VL9300-4TD40 = 4 x

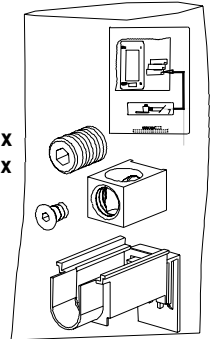

DE	Montage	EN	Assembly	FR	Montage
ES	Montaje	IT	Montaggio	PT	Montagem
TR	Montaj	PY	Монтаж	中文	安装

VL160X
3VL9100 4TC.0
3VL9100 4TD.0

1

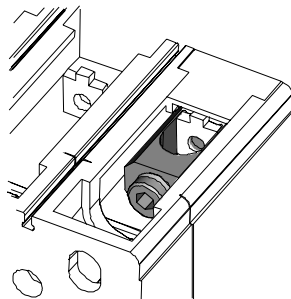
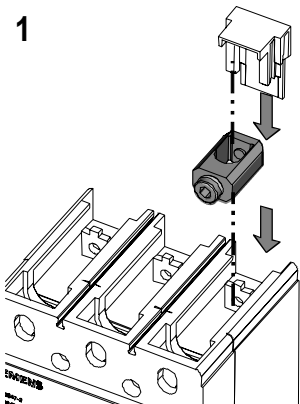

VL160X
3VL9200 4TC.0
3VL9200 4TD.0

1

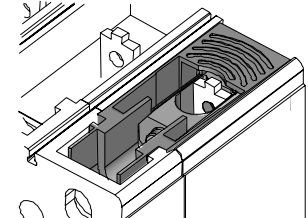
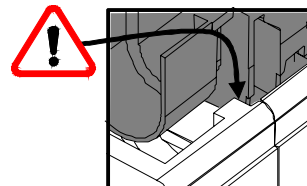
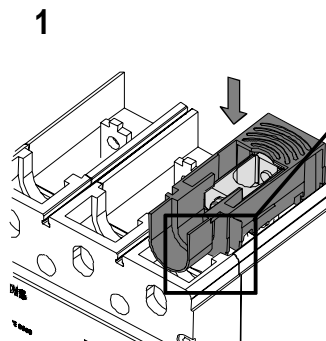

2

VL160X / VL160

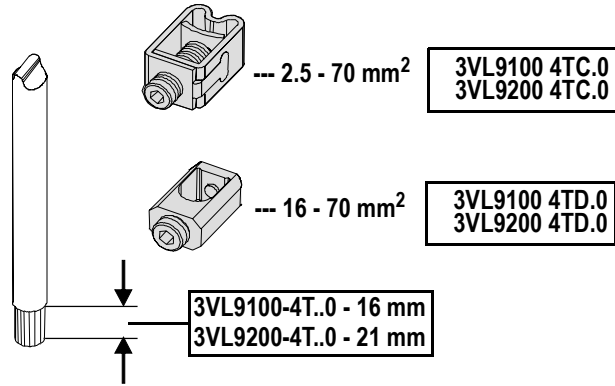

3

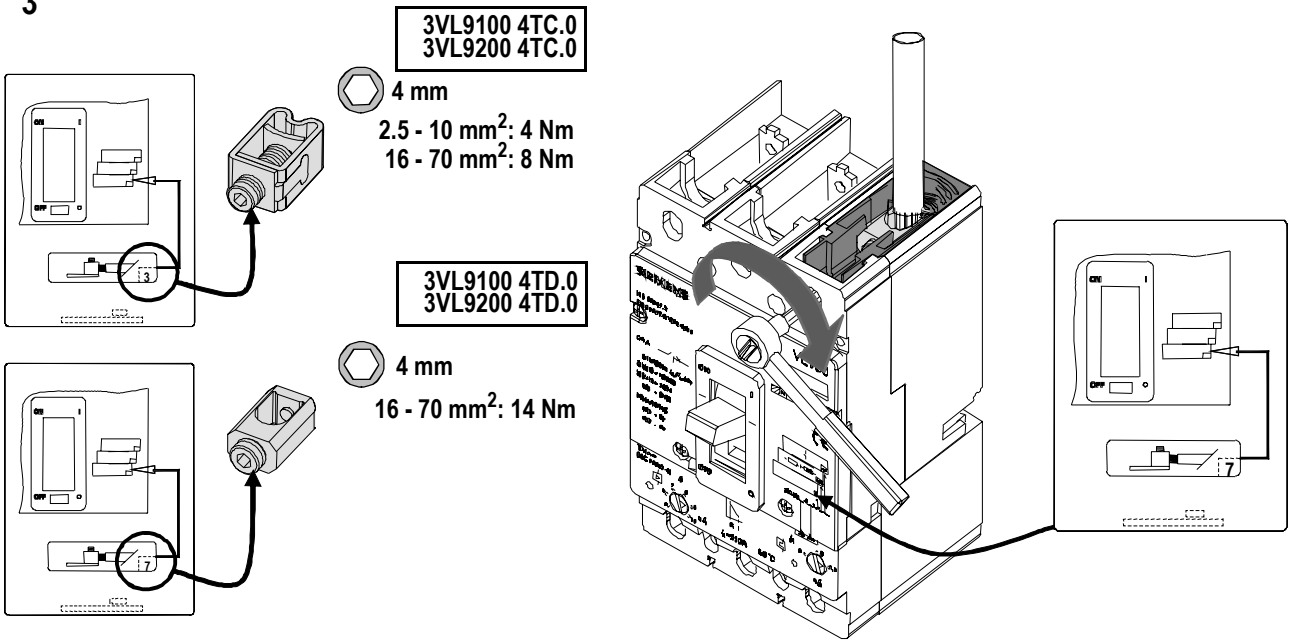

4

VL250

3VL9300 4TC.0

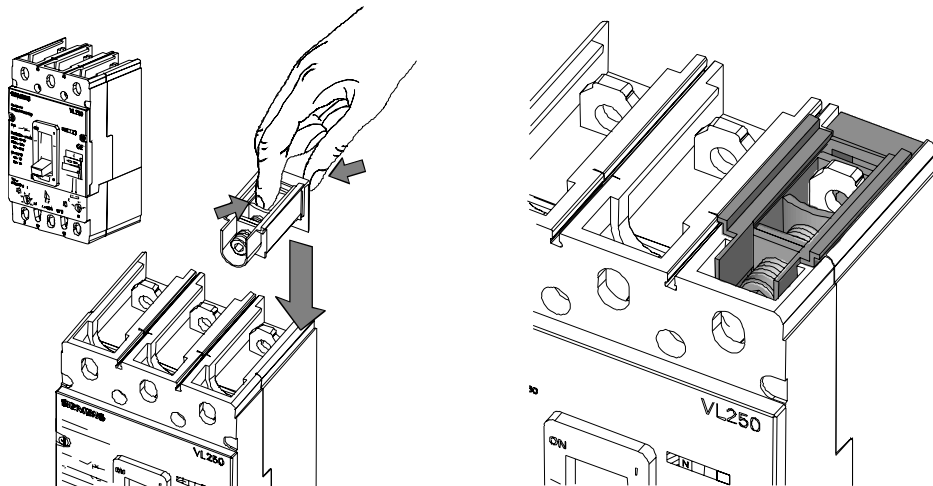

5

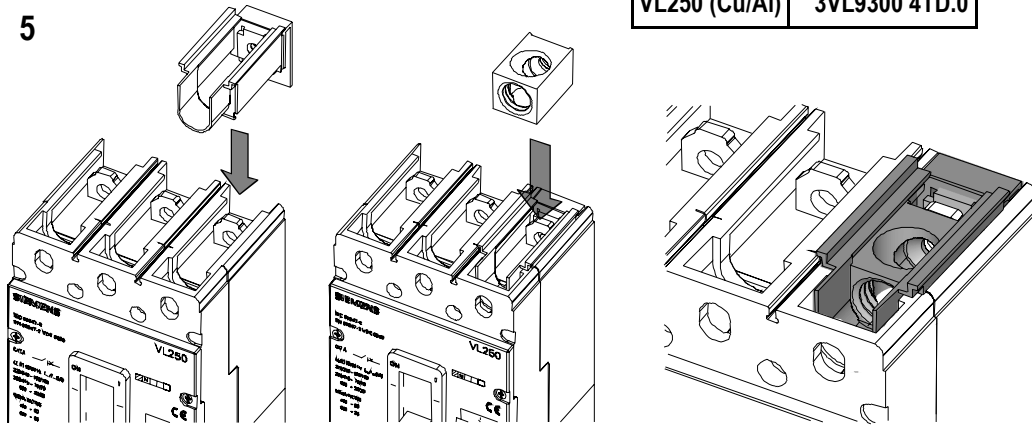

VL250 (Cu/Al) 3VL9300 4TD.0

6

VL250 (Cu/Al) 3VL9300 4TD.0

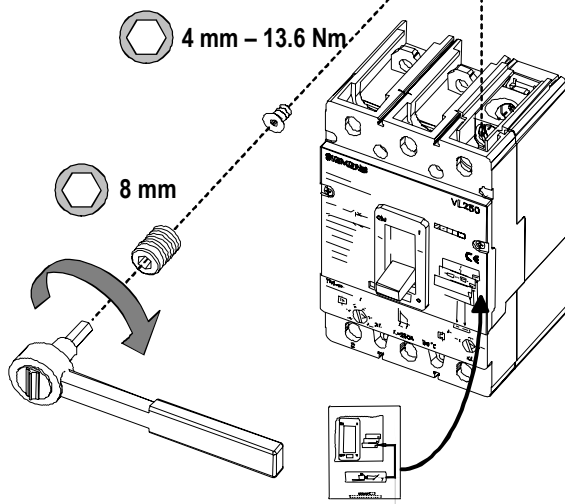

4 mm - 13.6 Nm

8 mm

VL250 (Cu, Cu/Al)

3VL9300 4TC.0
3VL9300 4TD.0

7

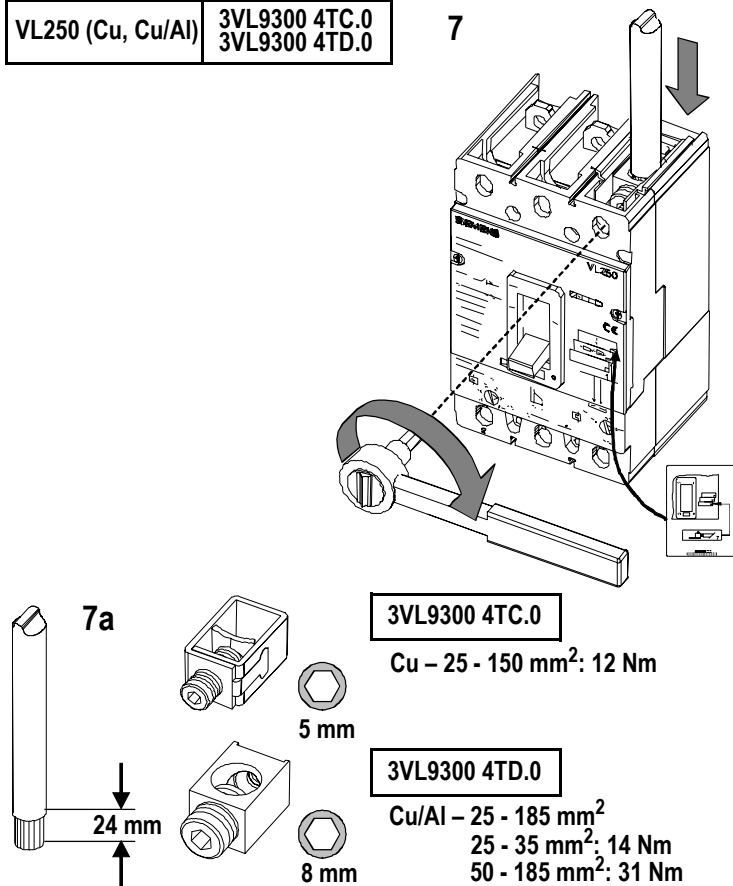

7a

24 mm

3VL9300 4TC.0

Cu - 25 - 150 mm²: 12 Nm

5 mm

3VL9300 4TD.0

Cu/Al - 25 - 185 mm²
25 - 35 mm²: 14 Nm
50 - 185 mm²: 31 Nm

DE	Weitere Informationen finden Sie im 3VL-Handbuch im Internet unter: www.siemens.com/lowvoltage/manuals/3VL (nur in Deutsch und Englisch)
EN	Further information can be found in the 3VL manual on the Internet under www.siemens.com/lowvoltage/manuals/3VL (only in German and English)
FR	Vous trouverez des informations supplémentaires dans le manuel 3VL dans Internet sous www.siemens.com/lowvoltage/manuals/3VL (seulement en allemand et en anglais)
ES	Para más información, consulte el manual 3VL que está disponible en nuestra página web www.siemens.com/lowvoltage/manuals/3VL (solo en alemán y inglés)
IT	Ulteriori informazioni sono disponibili in Internet nel manuale 3VL su www.siemens.com/lowvoltage/manuals/3VL (solo in tedesco e in inglese)
PT	Mais informações encontram-se no manual 3VL na Internet, sob www.siemens.com/lowvoltage/manuals/3VL (somente em alemão e em inglês)
TR	Diğer bilgileri internetde 3VL-el kitabında bulabilirsiniz: www.siemens.com/lowvoltage/manuals/3VL (yanliz almanca ve ingilizce)
PY	Дальнейшую информацию Вы можете найти в инструкции по использованию 3VL в интернете по адресу: www.siemens.com/lowvoltage/manuals/3VL (только по-немецки или по-английски)
中文	其他相关信息参见 3VL-使用手册, 请登陆互联网: www.siemens.com/lowvoltage/manuals/3VL (英、德文)